

Oklahoma Corporation Commission
Oil & Gas Conservation Division
Post Office Box 52000
Oklahoma City, Oklahoma 73152-2000
Rule 165: 10-3-25

Form 1002A

API No.: 35045228880000

Completion Report

Spud Date: March 12, 2010

OTC Prod. Unit No.: 045-204110

Drilling Finished Date: April 29, 2010

1st Prod Date: September 02, 2010

Completion Date: September 13, 2010

Drill Type: HORIZONTAL HOLE

Well Name: BERRYMAN 23 #1H

Purchaser/Measurer: DCP MIDSTREAM LP

Location: ELLIS 23 17N 24W
NE SW SE SE
400 FSL 1940 FWL of 1/4 SEC
Derrick Elevation: 0 Ground Elevation: 2283

First Sales Date: 09/17/2010

Operator: EOG RESOURCES INC 16231

3817 NW EXPWY STE 500
OKLAHOMA CITY, OK 73112-1483

Completion Type	
X	Single Zone
	Multiple Zone
	Commingled

Location Exception
Order No
There are no Location Exception records to display.

Increased Density
Order No
There are no Increased Density records to display.

Casing and Cement							
Type	Size	Weight	Grade	Feet	PSI	SAX	Top of CMT
CONDUCTOR	13 3/8	48	H-40	678		525	SURFACE
SURFACE	9 5/8	36	J-55	2214		665	SURFACE
INTERMEDIATE	7	26	P-110	10907		300	8109
PRODUCTION	4 1/2	13.5	P-110	14643		400	8664

Liner								
Type	Size	Weight	Grade	Length	PSI	SAX	Top Depth	Bottom Depth
There are no Liner records to display.								

Total Depth: 14643

Packer	
Depth	Brand & Type
10265	PACKER

Plug	
Depth	Plug Type
There are no Plug records to display.	

Initial Test Data										
Test Date	Formation	Oil BBL/Day	Oil-Gravity (API)	Gas MCF/Day	Gas-Oil Ratio Cu FT/BBL	Water BBL/Day	Pumpin or Flowing	Initial Shut-In Pressure	Choke Size	Flow Tubing Pressure
Sep 20, 2010	CHEROKEE	57	45	533	9351	112	FLOWING	780	50/64	193

Completion and Test Data by Producing Formation										
Formation Name: CHEROKEE			Code: 404CHRK			Class: OIL				
Spacing Orders				Perforated Intervals						
Order No		Unit Size		From			To			
572872		640		10980			14504			
Acid Volumes				Fracture Treatments						
There are no Acid Volume records to display.				FRAC W/14M GALS HCL + 1.545MM PROPPANT						

Formation	Top
OSWEGO	10355
VERDIGRIS	10553
CHEROKEE	10615

Were open hole logs run? No

Date last log run:

Were unusual drilling circumstances encountered? No

Explanation:

Other Remarks
There are no Other Remarks.

Lateral Holes
Sec: 23 TWP: 17N RGE: 24W County: ELLIS
NW SE NE NE
1943 FSL 1986 FWL of 1/4 SEC
Depth of Deviation: 9400 Radius of Turn: 1372 Direction: 360 Total Length: 3412
Measured Total Depth: 14643 True Vertical Depth: 10648 End Pt. Location From Release, Unit or Property Line: 654

FOR COMMISSION USE ONLY
Status: Accepted
1284

API NO. **045-22888**
 OTC PROD. UNIT NO. **045-204110**

PLEASE TYPE OR USE BLACK INK
 NOTE: Attach copy of original 1002A if recd



OKLAHOMA COMMISSION
 Form 1002A
 Rev. 2007
 OCT 01 2010

ORIGINAL
 AMENDED
 Reason Amended _____
 TYPE OF DRILLING OPERATION
 STRAIGHT HOLE _____ DIRECTIONAL HOLE _____ HORIZONTAL HOLE _____
 SERVICE WELL _____

SPUD DATE **3/12/10**
 DRLG FINISHED **4/29/10**

if directional or horizontal, see reverse for bottom hole location.
 COUNTY: **ELLIS** SEC **23** TWP **17N** RGE **24W**
 LEASE NAME: **BERRYMAN** WELL NO: **23 #1H**
 SHL: **NE 1/4 SW 1/4 SE 1/4 SE 1/4** FSL **400** FWL OF 1/4 SEC **1940**
 ELEVATION: _____ Longitude if known _____
 Derrick Fl _____ Ground **2283'** Latitude if known **35° 55' 37.7" N** Longitude if known **99° 43' 17.8" W**
 OPERATOR NAME **EOG RESOURCES, INC.** OTC/OCC OPER NO **16231-0**
 ADDRESS **3817 NW EXPRESSWAY, SUITE 500**
 CITY **OKLAHOMA CITY** STATE **OK** ZIP **73112**

WELL COMPLETION **9/13/10**
 1ST PROD DATE **9/2/10**
 RECOMP DATE _____

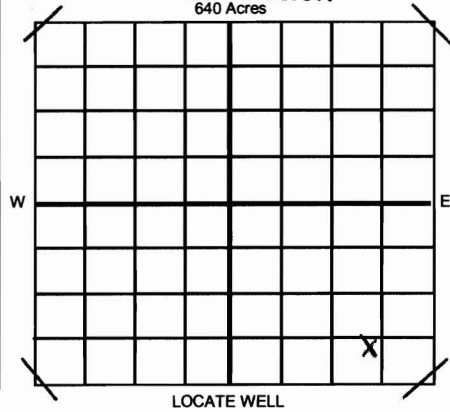

COMPLETION TYPE
 SINGLE ZONE
 MULTIPLE ZONE Application Date _____
 COMMINGLED Application Date _____
 LOCATION EXCEPTION ORDER NO. **N/A**
 INCREASED DENSITY ORDER NO. **N/A**

CASING & CEMENT (Form 1002C must be attached)

TYPE	SIZE	WEIGHT	GRADE	FEET	PSI	SAX	TOP
Conductor	13 3/8	48#	H-40	678		525	SURFACE
Surface	9 5/8	36#	J-55	2214		665	SURFACE
Intermediate	7"	26#	P-110	10907		300	8109
Production	4 1/2	13.5#	P-110	14643		400	8664
Liner							

PACKER @ **10265'** BRAND & TYPE _____ PLUG@ _____ TYPE _____ PLUG@ _____ TYPE _____ TOTAL DEPTH **14643 MD**
 PACKER @ _____ BRAND & TYPE _____ PLUG@ _____ TYPE _____ PLUG@ _____ TYPE _____

COMPLETION & TEST DATA BY PRODUCING **404CHRK**

FORMATION	CHEROKEE				
SPACING & SPACING ORDER NUMBER	640/572872				
CLASS: Oil, Gas, Dry, Inj.dsp.Comm Disp. svc	OIL				
PERFORATED INTERVALS	10980-14504'				
ACID/VOLUME Fracture Treatment (Fluids/Prop Amounts)	FRAC w/14M gals HCL + 1.545MM PROPPANT.				

Request minimum gas allowable Gas Purchaser/Measurer **DCP MIDSTREAM, LP** 1st Sales Date **9/17/10**

INITIAL TEST DATA

INITIAL TEST DATE	9/20/10				
OIL-BBL/DAY	57				
OIL-GRAVITY (API)	45				
GAS-MCF/DAY	533				
GAS-OIL RATIO CU FT/BBL	9351				
WATER-BBL/DAY	112				
PUMPING OR FLOWING	FLOWING				
INITIAL SHUT-IN PRESSURE	SICP 780				
CHOKE SIZE	50/64				
FLOW TUBING PRESSURE	193				

A record of the formations drilled through, and pertinent remarks are presented on the reverse. I declare that I have knowledge of the contents of this report and am authorized by my organization to make this report which was prepared by me or under my supervision and direction, with the data and facts stated herein to be true, correct, and complete to the best of my knowledge and belief.

Dawn Rockel
 SIGNATURE _____ NAME (PRINT OR TYPE) **DAWN ROCKEL** DATE **9/27/10** PHONE NUMBER **405/246-3226**
3817 NW EXPRESSWAY, STE. 500 OKLAHOMA CITY OK 73112
 ADDRESS _____ EMAIL ADDRESS _____

PLEASE TYPE OR USE BLACK INK ONLY
FORMATION RECORD

LEASE NAME BERRYMAN

WELL NO. 23 #1H

Give formation names and tops, if available, or descriptions and thickness of formations drilled through. Show intervals cored or drillstem tested.

NAME OF FORMATIONS	TOP
OSWEGO	10355'
VERDRIS	10553'
CHEROKEE	10615'

FOR COMMISSION USE ONLY

ITD on file YES NO
 APPROVED _____ DISAPPROVED _____

2) Reject Codes

Was open hole logs run? yes no

Date last log was run _____

Was CO2 encountered? yes no at what depths? _____

Was H2S encountered? yes no at what depths? _____

Were unusual drilling circumstances encountered? Yes No
 If yes, briefly explain: _____

Other remarks:

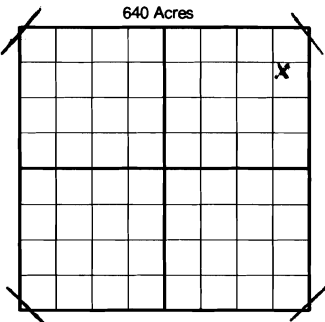

If more than two drainholes are proposed, attach a separate sheet indicating the necessary information.

Direction must be stated in degrees azimuth. Please note, the horizontal drainhole and its end point must be located within the boundaries of the lease or spacing unit.

Directional surveys are required for all drainholes and directional wells.

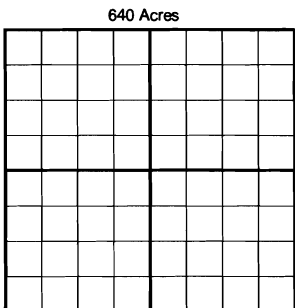

BOTTOM HOLE LOCATION FOR DIRECTIONAL HOLE

SEC	TWP	RGE	COUNTY
Spot Location 1/4 1/4 1/4 1/4			Feet From Quarter Section Lines FSL FWL
Measured Total Depth		True Vertical Depth	BHL From Lease, Unit or Property Line:

BOTTOM HOLE LOCATION FOR HORIZONTAL HOLE: (LATERALS)

LATERAL #1

SEC	TWP	RGE	COUNTY
23	17N	24W	ELLIS
Spot Location NW 1/4 SE 1/4 NE 1/4 NE 1/4			Feet From Quarter Section Lines 1943 FSL 1986 FWL
Depth of Deviation 9400' MD		Radius of Turn 1372' TVD	Direction 360 NORTH
Measured Total Depth 14643'		True Vertical Depth 10648'	Total Length 3412'
End Pt Location From Lease, Unit or Property Line: 654'			

LATERAL #2

SEC	TWP	RGE	COUNTY
Spot Location 1/4 1/4 1/4 1/4			Feet From Quarter Section Lines FSL FWL
Depth of Deviation		Radius of Turn	Direction
Measured Total Depth		True Vertical Depth	Total Length
End Pt Location From Lease, Unit or Property Line:			

LATERAL #3

SEC	TWP	RGE	COUNTY
Spot Location 1/4 1/4 1/4 1/4			Feet From Quarter Section Lines FSL FWL
Depth of Deviation		Radius of Turn	Direction
Measured Total Depth		True Vertical Depth	Total Length
End Pt Location From Lease, Unit or Property Line:			