

Oklahoma Corporation Commission
 Oil & Gas Conservation Division
 Post Office Box 52000
 Oklahoma City, Oklahoma 73152-2000
 Rule 165: 10-3-25

Form 1002A

API No.: 35137217570003

Completion Report

Spud Date: November 01, 1995

OTC Prod. Unit No.: 137-060677

Drilling Finished Date: January 12, 1996

1st Prod Date: March 14, 1996

Completion Date: March 27, 1996

Amended

Amend Reason: CASING SIZES AND DEPTHS

Drill Type: STRAIGHT HOLE

Well Name: DORIS A 1-30

Purchaser/Measurer: CHESAPEAKE OPERATING INC

Location: STEPHENS 30 2N 4W
 C SW4
 1320 FSL 1320 FWL of 1/4 SEC
 Derrick Elevation: 0 Ground Elevation: 0

First Sales Date: 03/14/1996

Operator: CHESAPEAKE OPERATING INC 17441
 P.O. Box 18496
 6100 N WESTERN AVE
 OKLAHOMA CITY, OK 73154-0496

Completion Type	
<input type="checkbox"/>	Single Zone
<input type="checkbox"/>	Multiple Zone
<input checked="" type="checkbox"/>	Commingled

Location Exception
Order No
There are no Location Exception records to display.

Increased Density
Order No
There are no Increased Density records to display.

Casing and Cement							
Type	Size	Weight	Grade	Feet	PSI	SAX	Top of CMT
SURFACE	10 3/4			5510		1900	SURFACE
INTERMEDIATE	7 5/8	33.7	P-110	14960		1100	5890
PRODUCTION	5 1/2	20	P110	14717		450	14717

Liner								
Type	Size	Weight	Grade	Length	PSI	SAX	Top Depth	Bottom Depth
LINER	4 1/2			2257	0	1823	14717	16974

Total Depth: 16980

Packer	
Depth	Brand & Type
14664	BAKER MAX

Plug	
Depth	Plug Type
16300	CIBP
16730	CIBP

Initial Test Data

Test Date	Formation	Oil BBL/Day	Oil-Gravity (API)	Gas MCF/Day	Gas-Oil Ratio Cu FT/BBL	Water BBL/Day	Pumpin or Flowing	Initial Shut-In Pressure	Choke Size	Flow Tubing Pressure
Mar 27, 1981	SYCAMORE- WOODFORD-HUNTON- VIOLA	61		3115	51066	97	FLOWING	1865	23/64	1200

Completion and Test Data by Producing Formation

Formation Name: SYCAMORE

Code: 352SCMR

Class: GAS

Spacing Orders

Order No	Unit Size
134872	640

Perforated Intervals

From	To
14820	14934

Acid Volumes

There are no Acid Volume records to display.

Fracture Treatments

YES, 10452 BBLS

Formation Name: WOODFORD

Code: 319WDFD

Class: GAS

Spacing Orders

Order No	Unit Size
393063	640

Perforated Intervals

From	To
14970	15232

Acid Volumes

There are no Acid Volume records to display.

Fracture Treatments

YES 6587 BBLS

Formation Name: HUNTON

Code: 269HNTN

Class: GAS

Spacing Orders

Order No	Unit Size
134872	640

Perforated Intervals

From	To
15339	15354

Acid Volumes

There are no Acid Volume records to display.

Fracture Treatments

YES 3385 BBLS

Formation Name: VIOLA

Code: 202VIOL

Class: GAS

Spacing Orders	
Order No	Unit Size
134872	640

Perforated Intervals	
From	To
15618	16138

Acid Volumes
There are no Acid Volume records to display.

Fracture Treatments
5982 BBLS

Formation Name: BROMIDE

Code: 202BRMD

Class: DRY

Spacing Orders	
Order No	Unit Size
42186	640

Perforated Intervals	
From	To
16536	16846

Acid Volumes
230 BBLS HCL

Fracture Treatments
530 BBLS

Formation Name: SYCAMORE-WOODFORD-HUNTON-VIOLA

Code:

Class: GAS

Formation	Top
SYCAMORE	14816
WOODFORD	14958
HUNTON	15354
VIOLA	15603
1ST BROMIDE	16284
2ND BROMIDE	16532
3RD BROMIDE	16681

Were open hole logs run? No

Date last log run:

Were unusual drilling circumstances encountered? No

Explanation:

Other Remarks
There are no Other Remarks.

FOR COMMISSION USE ONLY

Status: Accepted	283
------------------	-----

API NO. 137-21757
 OTC PROD. UNIT NO. 137-060677

PLEASE TYPE OR USE BLACK INK ONLY
 NOTE: Attach copy of original 1002A if recompleting



Form 1002A Rev. 2009
 RECEIVED

JUL 02 2010

ORIGINAL AMENDED
 Reason Amended CASING SIZES AND DEPTHS

TYPE OF DRILLING OPERATION
 STRAIGHT HOLE DIRECTIONAL HOLE HORIZONTAL HOLE
 SERVICE WELL
 If directional or horizontal, see reverse for bottom hole location.

COMPLETION REPORT
 SPUD DATE 11/1/1995
 DRLG FINISHED DATE 1/12/1996
 DATE OF WELL COMPLETION 3/27/1996
 1ST PROD DATE 3/14/1996
 RECOMP DATE

COUNTY STEPHENS SEC 30 TWP 2N RGE 4W
 LEASE NAME DORIS A WELL NO 1-30
 SHL 1/4 1/4 C SW 1/4 FSL 1,320 FWL OF 1/4 SEC 1,320
 ELEVATION Ground Latitude (if Known)
 Derrick Fl
 OPERATOR NAME CHESAPEAKE OPERATING, INC. OTC/OCC OPERATOR NO. 17441
 ADDRESS P.O. BOX 18496
 CITY OKLAHOMA CITY STATE OK ZIP 73154

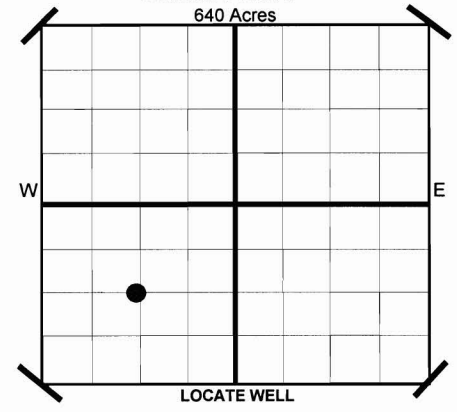

COMPLETION TYPE
 SINGLE ZONE
 MULTIPLE ZONE
 Application Date 413693
 COMMINGLED
 Application Date
 LOCATION EXCEPTION ORDER NO. N/A
 INCREASED DENSITY ORDER NO. N/A

CASING & CEMENT (Form 1002C must be attached)

TYPE	SIZE	WEIGHT	GRADE	FEET	PSI	SAX	TOP	
CONDUCTOR								
SURFACE	10 3/4			5510			Surface	
INTERMEDIATE	7 5/8	33.7	P-110	5890-14960			5890	
PRODUCTION	5 1/2	20	P-110	14717			14,717	
LINER	4 1/2			14717-16974		1823	14717	
							TOTAL DEPTH	16,980

PACKER @ 14664 BRAND & TYPE BAKER MAX
 PLUG @ 16300 TYPE CIBP
 PLUG @ 16730 TYPE CIBP

COMPLETION & TEST DATA BY PRODUCING FORMATION

FORMATION	SYCAMORE	WOODFORD	HUNTON	VIOLA	BROMIDE
SPACING & SPACING ORDER NUMBER	640 134872	640 393063	640 134872	640 134872	640 42186
CLASS: Oil, Gas, Dry, Inj, Disp, Comm Disp, Svc	GAS 14820-14934	GAS 14970-15232	GAS 15339-15354	GAS 15618-16138	DRY 16536-16846
PERFORATED INTERVALS					
ACID/VOLUME	N/A	N/A	N/A	N/A	230BBLs
FRACTURE TREATMENT (Fluids/Prop Amounts)	YES 10,452 BBLs	YES 6,587 BBLs	YES 3,385 BBLs	YES 5,982 BBLs	YES 530 BBLs

Minimum Gas Allowable (165-10-17-7) Gas Purchaser/Measurer Chesapeake Operating, Inc.
 OR
 Oil Allowable (165-10-13-3) 1st Sales Date 3/14/1996

INITIAL TEST DATA

INITIAL TEST DATE	3/27/1981
OIL-BBL/DAY	61
OIL-GRAVITY (API)	
GAS-MCF/DAY	3,115
GAS-OIL RATIO CU FT/BBL	51,066 COMINGLED
WATER-BBL/DAY	97
PUMPING OR FLOWING	FLOWING
INITIAL SHUT-IN PRESSURE	1865
CHOKE SIZE	23164 23164
FLOW TUBING PRESSURE	1200

A record of the formations drilled through, and pertinent remarks are presented on the reverse. I declare that I have knowledge of the contents of this report and am authorized by my organization to make this report, which was prepared by me or under my supervision and direction, with the data and facts stated herein to be true, correct, and complete to the best of my knowledge and belief.

Jim Corsoro JIM CORSORO - REGULATORY MANAGER 6/29/2010 405-848-8000
 SIGNATURE NAME (PRINT OR TYPE) DATE PHONE NUMBER
 P.O. BOX 18496 OKLAHOMA CITY OK 73154 arianna.bedell@chk.com
 ADDRESS CITY STATE ZIP EMAIL ADDRESS

PLEASE TYPE OR USE BLACK INK ONLY
FORMATION RECORD

Give formation names and tops, if available, or descriptions and thickness of formations drilled through. Show intervals cored or drillstem tested.

LEASE NAME DORIS A

WELL NO. 1-30

NAMES OF FORMATIONS	TOP
SYCAMORE	14,816'
WOODFORD	14,958'
HUNTON	15,354'
VIOLA	15,603'
1ST BROMIDE	16,284'
2ND BROMIDE	16,532'
3RD BROMIDE	16,681'

FOR COMMISSION USE ONLY	
ITD on file <input type="checkbox"/> YES <input type="checkbox"/> NO	
APPROVED _____	DISAPPROVED _____
2) Reject Codes	

Were open hole logs run? _____ yes <input checked="" type="checkbox"/> no
Date Last log was run _____
Was CO ₂ encountered? _____ yes <input checked="" type="checkbox"/> no at what depths? _____
Was H ₂ S encountered? _____ yes <input checked="" type="checkbox"/> no at what depths? _____
Were unusual drilling circumstances encountered? _____ yes <input checked="" type="checkbox"/> no If yes, briefly explain. _____

Other remarks:

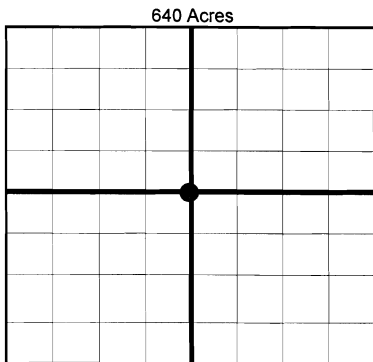

BOTTOM HOLE LOCATION FOR DIRECTIONAL HOLE

SEC	TWP	RGE	COUNTY							
Spot Location				1/4	1/4	1/4	1/4	Feet From 1/4 Sec Lines	FSL	FWL
Measured Total Depth		True Vertical Depth		BHL From Lease, Unit, or Property Line:						

BOTTOM HOLE LOCATION FOR HORIZONTAL HOLE: (LATERALS)

LATERAL #1

SEC	TWP	RGE	COUNTY							
Spot Location				1/4	1/4	1/4	1/4	Feet From 1/4 Sec Lines	FSL	FWL
Depth of Deviation		Radius of Turn		Direction		Total Length				
Measured Total Depth		True Vertical Depth		BHL From Lease, Unit, or Property Line:						

If more than three drainholes are proposed, attach a separate sheet indicating the necessary information.

Direction must be stated in degrees azimuth. Please note, the horizontal drainhole and its end point must be located within the boundaries of the lease or spacing unit.

Directional surveys are required for all drainholes and directional wells.

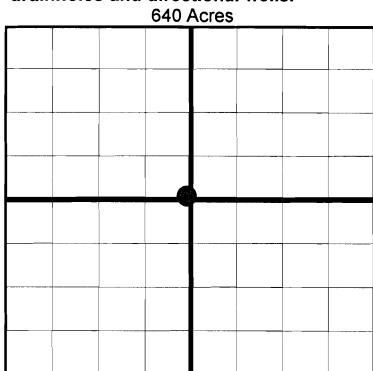

LATERAL #2

SEC	TWP	RGE	COUNTY							
Spot Location				1/4	1/4	1/4	1/4	Feet From 1/4 Sec Lines	FSL	FWL
Depth of Deviation		Radius of Turn		Direction		Total Length				
Measured Total Depth		True Vertical Depth		BHL From Lease, Unit, or Property Line:						

LATERAL #3

SEC	TWP	RGE	COUNTY							
Spot Location				1/4	1/4	1/4	1/4	Feet From 1/4 Sec Lines	FSL	FWL
Depth of Deviation		Radius of Turn		Direction		Total Length				
Measured Total Depth		True Vertical Depth		BHL From Lease, Unit, or Property Line:						