

6-9-14

Instructions

- A. Please type or print using black ink.
- B. Form must be signed by former operator and new operator.
- C. Outline boundaries of lease and spot well being transferred.
- D. Attach 1002A for well.
- E. Direct questions to Well Records (405) 521-2275.

OKLAHOMA CORPORATION COMMISSION

Oil & Gas Conservation Division
Post Office Box 52000
Oklahoma City, OK 73152-2000

Transfer of Operator
OAC 165:10-1-15

Form 1073
Rev. 2009

API No	35-065-00440	OTC Prod. Unit No.	
Location	1/4 SW 1/4 NE 1/4 NE 1/4	Sec. 14	Twp 1N Rge. 20W
Ft FSL of Qtr Sec	1,765	Ft FWL of Qtr Sec	1,740
County	Jackson		
Current Well Name/Number	Hunter HC # 2		
Original Well Name/Number			
Unit Name (if applicable)			

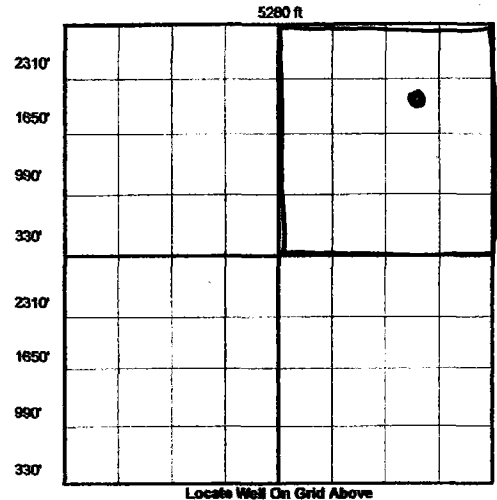

Well Class: ☒ OIL ☐ GAS ☐ DRY

Producing formation(s) Granite Wash

The effective date of transfer of this well, for the purposes of Commission records, is the date that the transfer is approved by the Commission.

CURRENT OPERATOR		OCC No. 19284
Name	Chanze Oil Co. Inc.	
Address	P.O. Box 1676	
City	Vernon	State TX Zip 76385
Phone No.	940-886-6510	FAX No./E-mail
I verify that I am the legal operator of record with authority to transfer operatorship of this well.		
Signature <u>Donna White</u>		
Name & Title (Typed or Printed) Donna White, Director & Vice President		
Signed and sworn to before me this 3rd day of June, 2014.		
My commission expires: 6/25/2016		

NEW OPERATOR		OCC No. 22183
Name	Fulcrum Exploration, LLC	
Address	3700 Forums Drive # 112	
City	Flower Mound	State TX Zip 75028
Phone No.	214-512-7610	FAX No./E-mail 972-874-2415
I verify that I am the legal operator of record with authority to transfer operatorship of this well.		
Signature <u>Derek Jensen, President</u>		
Name & Title (Typed or Printed) Derek Jensen, President		
Signed and sworn to before me this 4th day of June, 2014.		
My commission expires: 6-29-2014		

I verify under oath that I have exercised due diligence in attempting to locate the current operator of record according to OCC records, who has abandoned the above well/lease and cannot be located to obtain signature. I have attached a copy of the certified recorded assignment of lease.

* APPROVED COPY AVAILABLE ON OCC WEBSITE. *

Signature	
Signed and sworn to before me this _____ day of _____	
My commission expires: _____	
FOR OCC USE ONLY	
Surety Dept. <input checked="" type="checkbox"/> Approved <input type="checkbox"/> Rejected Date <u>JUN 10 2014</u>	Well Records Dept. <input checked="" type="checkbox"/> Approved <input type="checkbox"/> Rejected Date <u>WELL RECORDED</u>

NOTE: By processing this Form 1073, the Oklahoma Corporation Commission has approved the contents thereof as to form only. Oklahoma Corporation Commission does not warrant that the facts provided by the operator are true. Form is not approved until approved by Well Records.

Confirmed transfer w/ both operators S. Johnson