

Instructions

- A. Please type or print using black ink.
- B. Form must be signed by former operator and new operator.
- C. Outline boundaries of lease and spot well being transferred.
- D. Attach 1002A for well.
- E. Direct questions to Well Records (405) 521-2275.

OKLAHOMA CORPORATION COMMISSION

Oil & Gas Conservation Division
 Post Office Box 52000
 Oklahoma City, OK 73152-2000

Form 1073
 Rev. 2009

Transfer of Operator
 OAC 165:10-1-15

API No 125-20757		OTC Prod. Unit No. 125-57512	
Location SW 1/4 NE 1/4 NW 1/4 NW 1/4		Sec. 29	Twp. 7N
Ft FSL of Qtr Sec 2160		Ft FWL of Qtr Sec 890	Rge. 5E
County Pottawatomie			
Current Well Name/Number Radford #1			
Original Well Name/Number			
Unit Name (if applicable)			

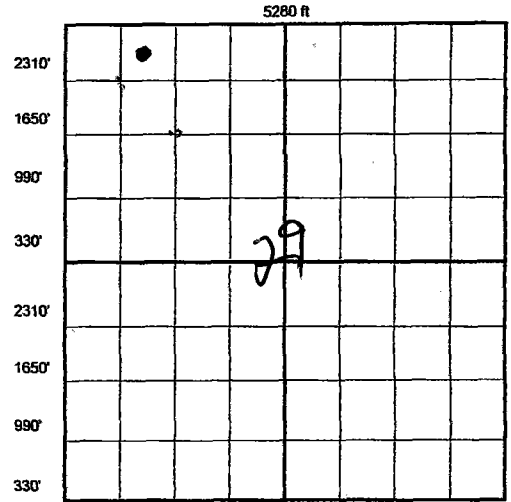

Well Class: OIL GAS DRY

Producing formation(s)

The effective date of transfer of this well, for the purposes of Commission records, is the date that the transfer is approved by the Commission.

CURRENT OPERATOR		OCC No. 04165
Name Hembree Brothers Oil Production		
Address PO Box 1725		
City Shawnee	State OK	Zip 74802
Phone No. 405-273-6137	FAX No./E-mail 405-273-6137	
I verify that I am the legal operator of record with authority to transfer operatorship of this well.		
Signature <i>Lewis A. Hembree</i>		
Name & Title (Typed or Printed) Lewis A Hembree Partner		
Signed and sworn to before me this 4th day of June, 2014.		
Notary Public <i>Karen B. Vallandingham</i> 12-6-14		

NEW OPERATOR		OCC No. 00999
Name Lewis A Hembree Production CO.		
Address PO Box 1725		
City Shawnee	State OK	Zip 74802
Phone No. 405-273-6137	FAX No./E-mail 405-273-3626	
I verify that I am the legal operator of record with authority to transfer operatorship of this well.		
Signature <i>Lewis A. Hembree</i>		
Name & Title (Typed or Printed) Lewis A Hembree President		
Signed and sworn to before me this 4th day of June, 2014.		
Notary Public <i>Karen B. Vallandingham</i> 12-6-14		

I verify under oath that I have exercised due diligence in attempting to locate the current operator of record according to OCC records, who has abandoned the above well/lease and cannot be located to obtain signature.

I have attached a copy of the certified recorded assignment of lease.

* APPROVED COPY AVAILABLE ON OCC WEBSITE. *

Signature _____

Signed and sworn to before me this _____ day of _____, _____

Notary Public

My commission expires: _____

FOR OCC USE ONLY

Surety Dept. Approved Rejected Date JUN 6 2014 Well Records Dept. Approved Rejected Date JUN 06 2014

NOTE: By processing this Form 1073, the Oklahoma Corporation Commission has approved the contents thereof as to form only. Oklahoma Corporation Commission does not warrant that the facts provided by the operator are true. Form is not approved until approved by Well Records.