

Instructions

- A. Please type or print using black ink.
- B. Form must be signed by former operator and new operator.
- C. Outline boundaries of lease and spot well being transferred.
- D. Attach 1002A for well.
- E. Direct questions to Well Records (405) 521-2275.

OKLAHOMA CORPORATION COMMISSION

Oil & Gas Conservation Division
 Post Office Box 52000
 Oklahoma City, OK 73152-2000

Transfer of Operator
 OAC 165:10-1-15

4-25-14

Form 1073
Rev. 2009

API No 125-03383		OTC Prod. Unit No. 125-07507	
Location 1/4 SW 1/4 NW 1/4 NW 1/4		Sec. 29	Twp. 7N
Ft FSL of Qtr Sec <u>650</u> 330		Ft FWL of Qtr Sec 330	County Pottawatomie
Current Well Name/Number H.T. Wolfe #4			
Original Well Name/Number			
Unit Name (if applicable)			

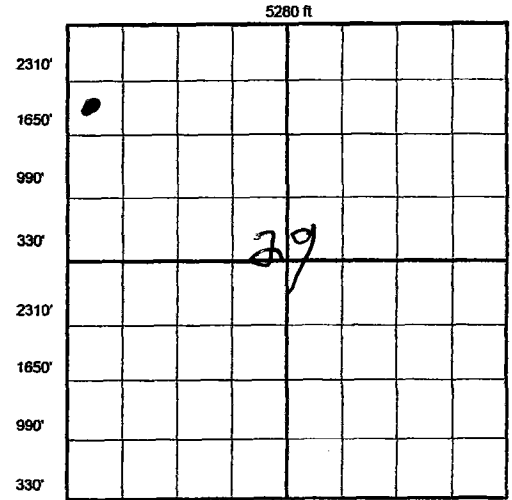

Well Class: OIL GAS DRY

Producing formation(s)

The effective date of transfer of this well, for the purposes of Commission records, is the date that the transfer is approved by the Commission.

CURRENT OPERATOR	OCC No.
Name Unknown to OCC, OTC shows 00999	
Address	
City	State Zip
Phone No.	FAX No./E-mail
I verify that I am the legal operator of record with authority to transfer operatorship of this well.	
Signature	
Name & Title (Typed or Printed)	
Signed and sworn to before me this ____ day of _____, _____.	
Notary Public	
My commission expires: _____	

NEW OPERATOR ✓	OCC No. 00999
Name Lewis A Hembree Production CO.	
Address PO Box 1725	
City Shawnee	State OK Zip 74802
Phone No. 405-273-6137	FAX No./E-mail 405-273-3626
I verify that I am the legal operator of record with authority to transfer operatorship of this well.	
Signature <i>Lewis A Hembree</i>	
Name & Title (Typed or Printed) Lewis A Hembree President	
Signed and sworn to before me this 23rd day of April, 2014.	
Notary Public <i>Karen B. Vallandingham</i>	
My commission expires: 12-6-14	

I verify under oath that I have exercised due diligence in attempting to locate the current operator of record according to OCC records, who has abandoned the above well/lease and cannot be located to obtain signature.

I have attached a copy of the certified recorded assignment of lease.

* APPROVED COPY AVAILABLE ON OCC WEBSITE. *

Signed and sworn to before me this 23rd day of April, 2014.

My commission expires: 12-6-14

FOR OCC USE ONLY

APR 28 2014

Surety Dept. Approved Rejected Date _____

Well Records Dept. Approved Rejected Date APR 28 2014

NOTE: By processing this Form 1073, the Oklahoma Corporation Commission has approved the contents thereof as to form only. Oklahoma Corporation Commission does not warrant that the facts provided by the operator are true. Form is not approved until approved by Well Records.

per API 125-03278
125-20448 which Notary seals OK DEN

WELL RECORDS