

Instructions

- A. Please type or print using black ink.
 B. Form must be signed by former operator and new operator.
 C. Outline boundaries of lease and spot well being transferred.
 D. Attach 1002A for well.
 E. Direct questions to Well Records (405) 521-2275.

OKLAHOMA CORPORATION COMMISSION

Oil & Gas Conservation Division
 Post Office Box 52000
 Oklahoma City, OK 73152-2000

Transfer of Operator
 OAC 165:10-1-15

Form 1073
 Rev. 2009

API No 125-03242		OTC Prod. Unit No.	
Location <u>C</u> NE 1/4 NE 1/4 SW 1/4 1/4	Sec. 19	Twp 7N	Rge. 5E
FLS of Qtr Sec <u>330 FNL</u>	FLS of Qtr Sec <u>330 FEL</u>	County Pottawatomie	
Current Well Name/Number Youts "C" #1			
Original Well Name/Number C.A. Youts #1			
Unit Name (if applicable) <u>CD # 26160193 Pooling # 575817</u>			

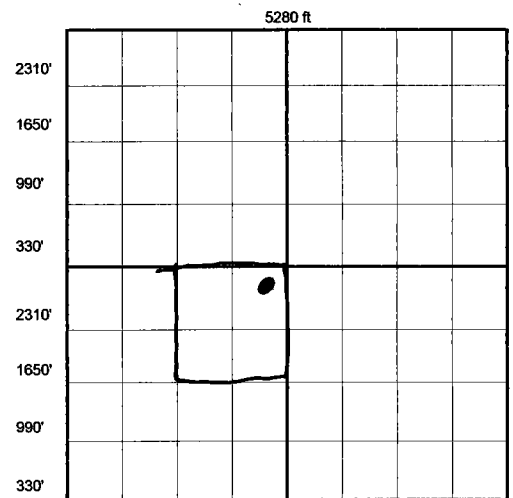

Well Class: ☒ OIL ☐ GAS ☐ DRY

Producing formation(s) Simpson Dolomite

The effective date of transfer of this well, for the purposes of Commission records, is the date that the transfer is approved by the Commission.

CURRENT OPERATOR		OCC No.
Name		
Address		
City	State	Zip
Phone No.	FAX No./E-mail	
I verify that I am the legal operator of record with authority to transfer operatorship of this well.		
Signature		
Name & Title (Typed or Printed)		
Signed and sworn to before me this _____ day of _____, _____.		
Notary Public		
My commission expires: _____		

NEW OPERATOR		OCC No. 00999
Name Lewis A Hembree Production Co		
Address PO Box 1725		
City Shawnee	State OK	Zip 74802
Phone No. 405-273-6137	FAX No./E-mail 405-273-8626	
I verify that I am the legal operator of record with authority to transfer operatorship of this well.		
Signature <u>Lewis A Hembree</u>		
Name & Title (Typed or Printed) Lewis A Hembree		
Signed and sworn to before me this <u>27th</u> day of <u>march</u> , <u>2014</u> .		
Notary Public <u>Karen B. Vallandigham</u>		
My commission expires: <u>12-6-14</u>		

I verify under oath that I have exercised due diligence in attempting to locate the current operator of record according to OCC records, who has abandoned the above well/lease and cannot be located to obtain signature. I have attached a copy of the certified recorded assignment of lease.

* APPROVED COPY AVAILABLE ON OCC WEBSITE. *

Signed and sworn to before me this 27th day of march, 2014.

My commission expires: 12-6-14

FOR OCC USE ONLY

Surety Dept. ☒ Approved ☐ Rejected Date APR 10 2014 Well Records Dept. ☒ Approved ☐ Rejected Date _____

NOTE: By processing this Form 1073, the Oklahoma Corporation Commission has approved the contents thereof as to form only. Oklahoma Corporation Commission does not warrant that the facts provided by the operator are true. Form is not approved until approved by Well Records.

OK OK

APR 10 2014