

Instructions

- A. Please type or print using black ink.
- B. Form must be signed by former operator and new operator.
- C. Outline boundaries of lease and spot well being transferred.
- D. Attach 1002A for well.
- E. Direct questions to Well Records (405) 521-2275.

OKLAHOMA CORPORATION COMMISSION

Oil & Gas Conservation Division
 Post Office Box 52000
 Oklahoma City, OK 73152-2000

8-13-13

Form 1073
 Rev. 2009

Transfer of Operator
 OAC 165:10-1-15

API No		095-00402		OTC Prod. Unit No.		095-035539	
Location							
1/4 NW		1/4 NE		1/4 SE		1/4	
				Sec. 16		Twp 5S Rge. 5E	
Ft FSL of Qtr Sec		2310'		Ft FWL of Qtr Sec		1650'	
				County Marshall			
Current Well Name/Number				Olmstead #1			
Original Well Name/Number				Olmsted "B" #1			
Unit Name (if applicable)							

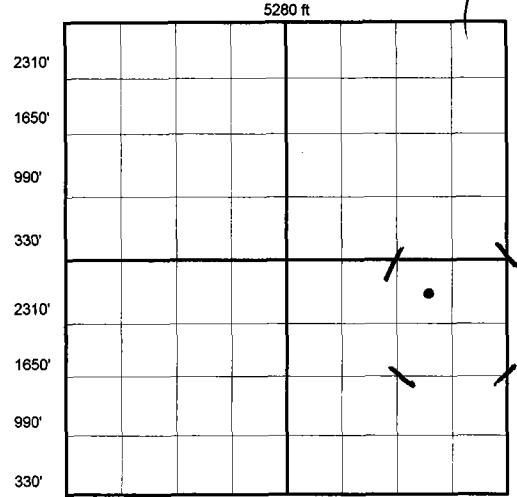

Locate Well On Grid Above

Well Class: OIL GAS DRY

Producing formation(s) VIOLA

The effective date of transfer of this well, for the purposes of Commission records, is the date that the transfer is approved by the Commission.

CURRENT OPERATOR		OCC No.	19960
Name: M-B OPERATING CO., INC.			
Address: P. O. Box 2266 2255			
City	ROWLETT	State	TX Zip 75030
Phone No.	972-475-1903	FAX No./E-mail	
I verify that I am the legal operator of record with authority to transfer operatorship of this well.			
Signature:			
Name & Title (Typed or Printed): Mike J. Considine, President			
Signed and sworn to before me this 30th day of July, 2013.			
My commission expires:			

NEW OPERATOR		OCC No.	22633
Name: GLADIATOR OPERATING, LLC			
Address: P. O. BOX 2562			
City	ARDMORE	State	OK Zip 73402
Phone No.	580-224-9291	FAX No./E-mail: GLADIATOROP@OUTLOOK.CO	
I verify that I am the legal operator of record with authority to transfer operatorship of this well.			
Signature:			
Name & Title (Typed or Printed): John R. Orr, Manager			
Signed and sworn to before me this 30th day of July, 2013.			
My commission expires:			

I verify under oath that I have exercised due diligence in attempting to locate the current operator of record according to OCC records, who has abandoned the above well/lease and cannot be located to obtain signature.

I have attached a copy of the certified recorded assignment of lease.

*** APPROVED COPY AVAILABLE ON OCC WEBSITE. ***

Signed and sworn to before me this _____ day of _____, _____

Signature _____
 Notary Public _____

My commission expires: _____
FOR OCC USE ONLY AUG 15 2013

Surety Dept. Approved Rejected Date _____ Well Records Dept. Approved Rejected Date _____

NOTE: By processing this Form 1073, the Oklahoma Corporation Commission has approved the contents thereof as to form only. Oklahoma Corporation Commission does not warrant that the facts provided by the operator are true. **Form is not approved until approved by Well Records.**

AUG 16 2013

WELL RECORDS APPROVED