

6-26-2013

**Instructions**

- A. Please type or print using black ink.
- B. Form must be signed by former operator and new operator.
- C. Outline boundaries of lease and spot well being transferred.
- D. Attach 1002A for well.
- E. Direct questions to Well Records (405) 521-2275.

**OKLAHOMA CORPORATION COMMISSION**

Oil & Gas Conservation Division  
 Post Office Box 52000  
 Oklahoma City, OK 73152-2000

Form 1073  
Rev. 2009

**Transfer of Operator**  
 OAC 165:10-1-15

API No	35-009-21643	OTC Prod. Unit No.	009-200120
Location	1/4 1/4 C 1/4 SE 1/4	Sec. 15	Twp 10N Rge. 26W
Ft FSL of Qtr Sec	1,320	Ft FWL of Qtr Sec	1,320
County	BECKHAM		
Current Well Name/Number	THOMPSON #2-15		
Original Well Name/Number			
Unit Name (if applicable)			

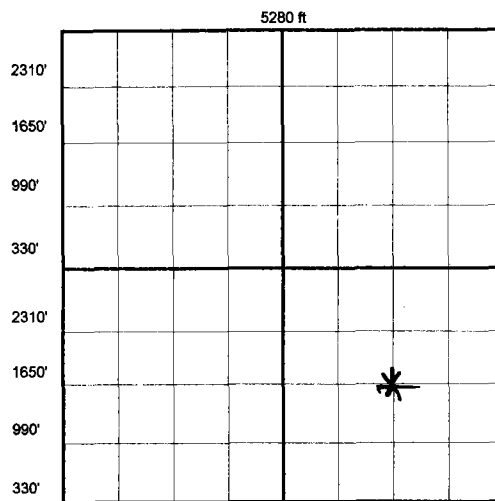

Well Class:  OIL  GAS  DRY

Producing formation(s) **DES MOINES/ GRANITE WASH**

The effective date of transfer of this well, for the purposes of Commission records, is the date that the transfer is approved by the Commission.

<b>CURRENT OPERATOR</b>	OCC No. 22678
Name	CISCO OPERATING, LLC
Address	6900 NORTH DALLAS PKWY STE 740
City	PLANO State TX Zip 75024
Phone No.	214-291-9987 FAX No./E-mail 214-291-9985
I verify that I am the legal operator of record with authority to transfer operatorship of this well.	
<i>[Signature]</i>	
Signature	
Name & Title (Typed or Printed)	
Signed and sworn to before me this 20th day of June, 2013.	
My commission expires: 4/7/2016	

<b>NEW OPERATOR</b>	OCC No. 21686
Name	WYNN-CROSBY OPERATING, LP
Address	14241 DALLAS PKWY STE 800
City	DALLAS State TX Zip 75254
Phone No.	972-354-1367 FAX No./E-mail 972-380-9570
I verify that I am the legal operator of record with authority to transfer operatorship of this well.	
<i>[Signature]</i>	
Signature	
Name & Title (Typed or Printed)	
Signed and sworn to before me this 20th day of June, 2013.	
My commission expires: 4/7/2016	

I verify under oath that I have exercised due diligence in attempting to locate the current operator of record according to OCC records, who has abandoned the above well/lease and cannot be located to obtain signature.

I have attached a copy of the certified recorded assignment of lease.

\* APPROVED COPY AVAILABLE ON OCC WEBSITE. \*

Signature \_\_\_\_\_

Signed and sworn to before me this \_\_\_\_\_ day of \_\_\_\_\_, \_\_\_\_\_.

Notary Public

My commission expires: \_\_\_\_\_  
**FOR OCC USE ONLY** JUL 01 2013

JUL 11 2013

Surety Dept.  Approved  Rejected Date \_\_\_\_\_ Well Records Dept.  Approved  Rejected Date \_\_\_\_\_

**WELL RECORDS APPROVED**

NOTE: By processing this Form 1073, the Oklahoma Corporation Commission has approved the contents thereof as to form only. Oklahoma Corporation Commission does not warrant that the facts provided by the operator are true. Form is not approved until approved by Well Records.