

Instructions

- A. Please type or  black ink.
- B. Form must be signed by former operator and new operator.
- C. Outline boundaries of lease and spot well being transferred.
- D. Attach 1002A for well.
- E. Questions should be directed to Well Records (405) 521-2275.

OKLAHOMA CORPORATION COMMISSION

Oil & Gas Conservation Division
 Post Office Box 52000
 Oklahoma City, OK 73152-2000

7/2/2013

Form 1073
Rev. 2001

Transfer of Operator
OAC 165:10-1-15

API No. 09322260	OTC Prod. Unit No. 093-69912	Location		Sec. 32	Twp. 23N	Rge. 9W
Ft FSL of Qtr Sec 660	Ft FWL of Qtr Sec 1980	County		Major		
Current Well Name/No. Stevens #1						
Original Well Name/No. Stevens #1						
Unit Name (if applicable)						

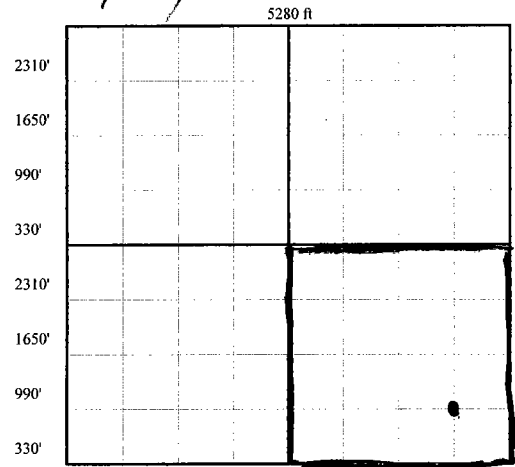

Locate Well On Grid Above

Well Class: Oil Gas Dry Plugged

Producing formation(s) Mississippi Manning	Oil Transporter/Purchaser J P ENERGY PARTNERS	OTC No. 22565
Gas Measurer ATLAS PIPELINE MID-CONTINENT		OTC No. 22250

The effective date of transfer of this well for the purposes of Commission records, is the date the transfer is approved by the Commission.

CURRENT OPERATOR

Name TE-RAY Resources, Inc.	OCC No. 20522
Address 1105 Sovereign Row Unit C	
City Oklahoma City	State OK
Zip 73108	
Phone No. 405-232-4121	FAX No. 405-232-4170

I verify that I am the legal operator of record with authority to transfer operatorship of this well.

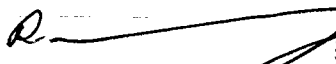
Signature: 

Name & Title (Typed or Printed)
R. Dean Manning, President

Signed and sworn to before me this 15th day of May 2013

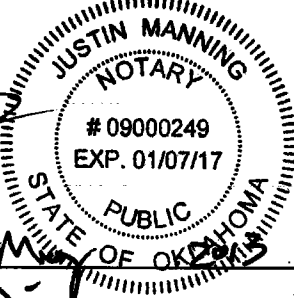
Notary Public: 

My commission expires:

NEW OPERATOR

Name Clay A. Muegge	OCC No. 18496
Address 16489 County Road 1060	
City Lamont	State OK
Zip 74643	
Phone No. 580-541-9573	FAX No. 580-388-4559

Being the new operator, as of the effective date and time of transfer accept the facts presented as being true and correct and accept the operational responsibility for the well on the described property.

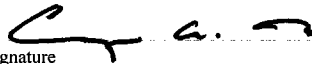
Signature: 

Name & Title (Typed or Printed)
Clay A. Muegge, Owner

Signed and sworn to before me this 24th day of July 2013

Notary Public: 

My commission expires: 12/31/13

I verify under oath that I have exercised due diligence in attempting to locate the current operator of record according to OCC records, who has abandoned the above well/lease and cannot be located to obtain signature. I have attached a copy of the certified recorded assignment of lease.

Signature

Signed and sworn to before me this _____ day of _____

Notary Public

My commission expires: _____

FOR OCC USE ONLY

Surety Dept. Approved Rejected Date JUL 05 2013 Well Records Dept. Approved Rejected

JUL 08 2013

WELL RECORDS APPROVED

NOTE: By processing this Form 1073, the Oklahoma Corporation Commission has approved the contents thereof as to form only. Oklahoma Corporation Commission does not warrant that the facts provided by the operator are true. Form is not approved until approved by Well Records.

256c-55