

**Instructions**

- A. Please type or print using black ink.
- B. Form must be signed by former operator and new operator.
- C. Outline boundaries of lease and spot well being transferred.
- D. Attach 1002A for well.
- E. Direct questions to Well Records (405) 521-2275.

**OKLAHOMA CORPORATION COMMISSION**

Oil & Gas Conservation Division  
 Post Office Box 52000  
 Oklahoma City, OK 73152-2000

Form 1073  
 Rev. 2009

7/2/2013

**Transfer of Operator**  
 OAC 165:10-1-15

API No	039-21182	OTC Prod. Unit No.	039-07316
Location	1/4 NW 1/4 NW 1/4 SE 1/4	Sec. 18	Twp 15N Rge. 17W
Ft FSL of Qtr Sec	2,490	Ft FWL of Qtr Sec	660
County	CUSTER		
Current Well Name/Number	COIT # 1-18		
Original Well Name/Number	COIT # 1-18		
Unit Name (if applicable)			

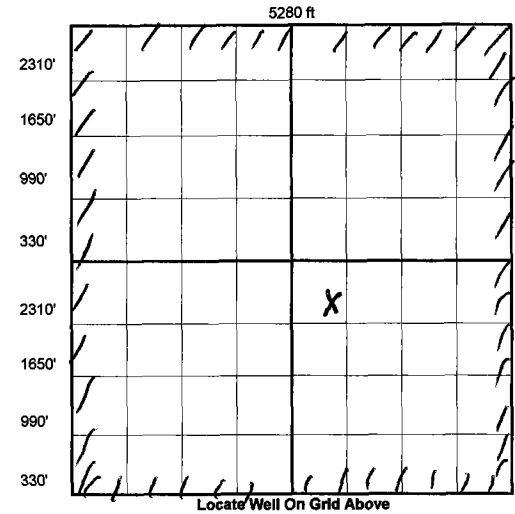

Well Class:  OIL  GAS  DRY

Producing formation(s) **BRITT SPRINGER**

**The effective date of transfer of this well, for the purposes of Commission records, is the date that the transfer is approved by the Commission.**

<b>CURRENT OPERATOR</b>	OCC No. 06211
Name	MARSHALL OIL CORPORATION
Address	P. O. Box 54625
City	Oklahoma City State Ok Zip 73154-1625
Phone No.	405-286-3338 FAX No./E-mail dg@dgooldlaw.com
I verify that I am the legal operator of record with authority to transfer operatorship of this well.	
Signature	<i>[Signature]</i>
Name & Title (Typed or Printed) Douglas N. Gould, Trustee	
Signed and sworn to before me this <u>3</u> day of July, 2013.	
My commission expires: _____	

<b>NEW OPERATOR</b>	OCC No. 20983
Name	GULF EXPLORATION, L.L.C.
Address	9701 N. Broadway Extension
City	Oklahoma City State Ok Zip 73114
Phone No.	405-840-3371 FAX No./E-mail pmcgraw@gulfexploration.com
I verify that I am the legal operator of record with authority to transfer operatorship of this well.	
Signature	<i>[Signature]</i>
Name & Title (Typed or Printed) Al Salomone, Co-Manager	
Signed and sworn to before me this <u>3</u> day of July, 2013.	
My commission expires: _____	

I verify under oath that I have exercised due diligence in attempting to locate the current operator of record according to OCC records, who has abandoned the above well/lease and cannot be located to obtain signature. I have attached a copy of the certified recorded assignment of lease.

\* APPROVED COPY AVAILABLE ON OCC WEBSITE. \*

Signature \_\_\_\_\_

Signed and sworn to before me this \_\_\_\_\_ day of \_\_\_\_\_, \_\_\_\_\_

Notary Public

My commission expires: JUL 05 2013

FOR OCC USE ONLY

Surety Dept.  Approved  Rejected Date \_\_\_\_\_

Well Records Dept.  Approved  Rejected Date \_\_\_\_\_

**WELL RECORDS**  
 APPROVED

NOTE: By processing this Form 1073, the Oklahoma Corporation Commission has approved the contents thereof as to form only. Oklahoma Corporation Commission does not warrant that the facts provided by the operator are true. Form is not approved until approved by Well Records.