

6/4/2013

Instructions

- A. Please type or print using black ink.
- B. Form must be signed by former operator and new operator.
- C. Outline boundaries of lease and spot well being transferred.
- D. Attach 1002A for well.
- E. Direct questions to Well Records (405) 521-2275.

OKLAHOMA CORPORATION COMMISSION
 Oil & Gas Conservation Division
 Post Office Box 52000
 Oklahoma City, OK 73152-2000

Transfer of Operator
 OAC 165:10-1-15

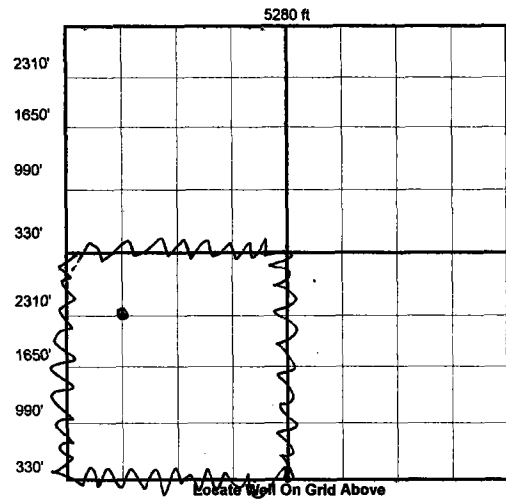

API No	083-23486-A		OTC Prod. Unit No.	083-100831	
Location	1/4	1/4 NW	1/4 SW	1/4	Sec. 23-34 Twp 17N Rge. 3W
Ft FSL of Qtr Sec	1,980	Ft FWL of Qtr Sec	660	365	County LOGAN
Current Well Name/Number	MILLER #2-23				
Original Well Name/Number	MILLER #2-23				
Unit Name (if applicable)	MIDWAY LOWER LAYTON SAND UNIT				

Well Class: OIL GAS DRY **NSW**

Producing formation(s) **PAWHUSKA TONKAWA**

The effective date of transfer of this well, for the purposes of Commission records, is the date that the transfer is approved by the Commission.

CURRENT OPERATOR	OCC No. 19935
Name	NEWKUMET EXPLORATON, INC.
Address	P. O. BOX 11330
City	MIDLAND TX Zip 79702
Phone No.	FAX No./E-mail
I verify that I am the legal operator of record with authority to transfer operatorship of this well.	
Signature	<i>[Signature]</i>
Name & Title (Typed or Printed)	WAYNE NEWKUMET, PRESIDENT
Signed and sworn to before me this <u>24th</u> day of <u>MAY</u> , 2013.	

NEW OPERATOR	OCC No. 17313
Name	SLAWSON EXPLORATION CO., INC.
Address	204 N Robinson #2300
City	OKC OK Zip 73102
Phone No.	405 232 0201 FAX No./E-mail 405 235 5134
I verify that I am the legal operator of record with authority to transfer operatorship of this well.	
Signature	<i>[Signature]</i>
Name & Title (Typed or Printed)	Steve Slawson, VP-Operations
Signed and sworn to before me this <u>31</u> day of <u>MAY</u> , 2013.	

I verify under oath that I have exercised due diligence in attempting to locate the current operator of record according to OCC records, who has abandoned the above well/lease and cannot be located to obtain signature. I have attached a copy of the certified recorded assignment of lease.

* APPROVED COPY AVAILABLE ON OCC WEBSITE. *

Signature _____
 Signed and sworn to before me this _____ day of _____, _____
 Notary Public

My commission expires: _____
FOR OCC USE ONLY
 Surety Dept. Approved Rejected Date JUN 06 2013 Well Records Dept. Approved Rejected Date WELL RECORDS

NOTE: By processing this Form 1073, the Oklahoma Corporation Commission has approved the contents thereof as to form only. Oklahoma Corporation Commission does not warrant that the facts provided by the operator are true. Form is not approved until approved by Well Records.

JUN 06 2013
WELL RECORDS APPROVED