

Instructions

- A. Please type or print using black ink.
- B. Form must be signed by former operator and new operator.
- C. Outline boundaries of lease and spot well being transferred.
- D. Attach 1002A for well.
- E. Direct questions to Well Records (405) 521-2275.

OKLAHOMA CORPORATION COMMISSION

Oil & Gas Conservation Division
 Post Office Box 52000
 Oklahoma City, OK 73152-2000

Form 1073
 Rev. 2009

Transfer of Operator
 OAC 165:10-1-15

API No	049-23869		OTC Prod. Unit No.	049-98602	
Location	C	1/4 NE	1/4 NW	1/4 NE	1/4
				Sec. 5	Twp 3N Rge. 2E
Ft FSL of Qtr Sec	2,310		Ft FWL of Qtr Sec	990	
County	Garvin				
Current Well Name/Number	Tucker #1-A				
Original Well Name/Number					
Unit Name (if applicable)					

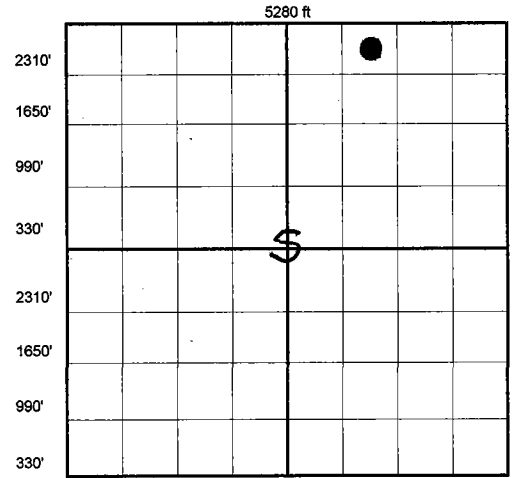

Locate Well On Grid Above

Well Class: OIL GAS DRY

Producing formation(s) Dykeman Sand

The effective date of transfer of this well, for the purposes of Commission records, is the date that the transfer is approved by the Commission.

CURRENT OPERATOR	OCC No. 20068
Name	United Production Company, LLC
Address	1001 NW 139th Street Parkway
City	Edmond
State	OK
Zip	73013
Phone No.	405-728-8900
FAX No./E-mail	405-728-5689
I verify that I am the legal operator of record with authority to transfer ownership of this well.	
Signature	<i>[Signature]</i>
Name & Title (Typed or Printed)	Joseph H. Hamra, Jr. - Manager
Signed and sworn to before me this <u>10th</u> day of <u>April</u> , 2013.	
My commission expires _____	

NEW OPERATOR	OCC No. 02902-0
Name	BBR Oil Corporation
Address	10 W. Main, Suite 212
City	Ardmore
State	OK
Zip	73401
Phone No.	580-223-2887
FAX No./E-mail	580-223-2888
I verify that I am the legal operator of record with authority to transfer ownership of this well.	
Signature	<i>[Signature]</i>
Name & Title (Typed or Printed)	Michael J. Biddick - Vice President
Signed and sworn to before me this <u>12th</u> day of <u>April</u> , 2013.	
My commission expires <u>11-16-2013</u>	

I verify under oath that I have exercised due diligence in attempting to locate the current operator of record according to OCC records, who has abandoned the above well/lease and cannot be located to obtain signature.

I have attached a copy of the certified recorded assignment of lease.

* APPROVED COPY AVAILABLE ON OCC WEBSITE. *

Signature _____

Signed and sworn to before me this _____ day of _____, _____

Notary Public APR 16 2013

My commission expires: _____

FOR OCC USE ONLY

Surety Dept. Approved Rejected Date APR 16 2013 Well Records Dept. Approved Rejected Date _____

WELL RECORDS APPROVED

NOTE: By processing this Form 1073, the Oklahoma Corporation Commission has approved the contents thereof as to form only. Oklahoma Corporation Commission does not warrant that the facts provided by the operator are true. Form is not approved until approved by Well Records.