

Instructions

- A. Please type or print using black ink.
- B. Form must be signed by former operator and new operator.
- C. Outline boundaries of lease and spot well being transferred.
- D. Attach 1002A for well.
- E. Direct questions to Well Records (405) 521-2275.

OKLAHOMA CORPORATION COMMISSION

Oil & Gas Conservation Division
 Post Office Box 52000
 Oklahoma City, OK 73152-2000

Transfer of Operator
 OAC 165:10-1-15

3/18/13

Form 1073
 Rev. 2009

API No	35-129-23474	OTC Prod. Unit No.	129-205228-0-0000
Location	NW 1/4 NE 1/4 NE 1/4 NW 1/4	Sec. 14	Twp 16N Rge. 26W
Ft FSL of Qtr Sec	200' FNL	Ft FWL of Qtr Sec	2180' FWL
County	Roger Mills		
Current Well Name/Number	Noble Fred 11-1H		
Original Well Name/Number	Noble Fred 11-1H		
Unit Name (if applicable)			

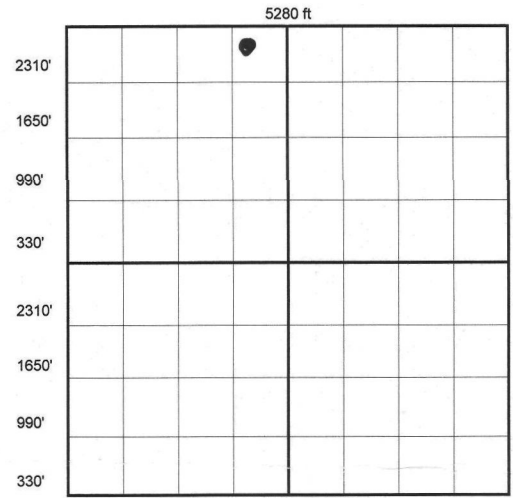

Locate Well On Grid Above

Well Class: OIL GAS DRY

Producing formation(s) Cleveland

The effective date of transfer of this well, for the purposes of Commission records, is the date that the transfer is approved by the Commission.

CURRENT OPERATOR	OCC No. <u>22738</u>
Name	Le Norman Operating LLC
Address	4727 Gaillardia Parkway, Suite 200
City	Oklahoma City
State	OK
Zip	73142
Phone No.	405-548-1200
FAX No./E-mail	
I verify that I am the legal operator of record with authority to transfer operatorship of this well.	
Signature <u>David D. Le Norman, President & CEO</u>	
Name & Title (Typed or Printed)	
Signed and sworn to before me this <u>14th</u> day of <u>March</u> , <u>2013</u> .	
My commission expires: <u>6-17-14</u>	

NEW OPERATOR	OCC No. <u>23159</u>
Name	Sabine Oil & Gas LLC
Address	1415 Louisiana, Suite 1600
City	Houston
State	TX
Zip	77002
Phone No.	832-242-9635
FAX No./E-mail	
I verify that I am the legal operator of record with authority to transfer operatorship of this well.	
Signature <u>Dianne Sumrall - Mgr Reg & Prod Actg</u>	
Name & Title (Typed or Printed)	
Signed and sworn to before me this <u>14th</u> day of <u>March</u> , <u>2013</u> .	
My commission expires: <u>6-17-14</u>	

I verify under oath that I have exercised due diligence in attempting to locate the current operator of record according to OCC records, who has abandoned the above well/lease and cannot be located to obtain signature.

I have attached a copy of the certified recorded assignment of lease.

* APPROVED COPY AVAILABLE ON OCC WEBSITE. *

Signature _____

Signed and sworn to before me this _____ day of _____, _____.

Notary Public

My commission expires: _____

FOR OCC USE ONLY

Surety Dept. Approved Rejected Date MAR 19 2013 Well Records Dept. Approved Rejected Date MAR 19 2013

NOTE: By processing this Form 1073, the Oklahoma Corporation Commission has approved the contents thereof as to form only. Oklahoma Corporation Commission does not warrant that the facts provided by the operator are true. Form is not approved until approved by Well Records.