

Instructions

- A. Please type or print using black ink.
 B. Form must be signed by former operator and new operator.
 C. Outline boundaries of lease and spot well being transferred.
 D. Attach 1002A for well.
 E. Questions should be directed to Well Records (405) 521-2275.

OKLAHOMA CORPORATION COMMISSION

Oil & Gas Conservation Division
 Post Office Box 52000
 Oklahoma City, OK 73152-2000

Transfer of Operator

OAC 165:10-1-15

Form 1073
 Rev. 2001

API No. 3 5 0 7 3 2 2 6 7 3		OTC Prod. Unit No. 73-65352	
Location 1/4 1/4 NE 1/4 SE 1/4		Sec. 3 4	Twp. 1 5 N
Ft FSL of Qtr Sec 1980		Ft FWL of Qtr Sec 1980	
Current Well Name/No. Dickerson 1-34		County Kingfisher	
Original Well Name/No.			
Unit Name (if applicable)			

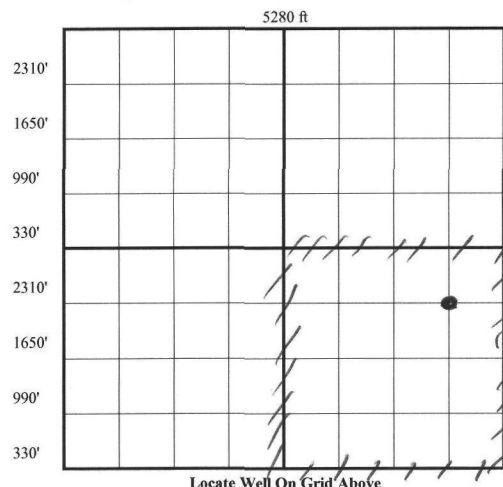

Well Class: ☒ Oil ☐ Gas ☐ Dry ☐ Plugged

Producing formation(s) PRUE	
Oil Transporter/Purchaser	OTC No.
Gas Measurer	OTC No.

The effective date of transfer of this well for the purposes of Commission records, is the date the transfer is approved by the Commission.

CURRENT OPERATOR

Name Jenex Petroleum Corporation		OCC No. 2 3 0 7 6
Address 9 5 9 5 Six Pines Drive Suite 8210		
City The Woodlands	State TX	Zip 7 7 3 8 0
Phone No. 7 1 3 - 6 2 3 - 1 6 4 4	FAX No. 8 3 2 - 4 3 6 - 1 6 8 4	
I verify that I am the legal operator of record with authority to transfer operatorship of this well.		
Signature 		
Name & Title (Typed or Printed) Brett Jensen, President Jenex Petroleum Company		

Notary Public, State of Texas
 My Commission Expires **June 14, 2016**
 Signed and sworn to before me this **February 26, 2013** day of **February**, 2013
 Notary Public

NEW OPERATOR

Name JEC Operating, L.L.C.		OCC No. 2 0 9 1 1
Address 921 E. Britton Rd.		
City Oklahoma City	State OK	Zip 7 3 1 1 4
Phone No. 4 0 5 - 7 5 3 - 4 4 9 2	FAX No.	
Being the new operator, as of the effective date and time of transfer accept the facts presented as being true and correct and accept the operational responsibility for the well on the described property.		
Signature 		
Name & Title (Typed or Printed) Russell Johnson, III, Manager		
Signed and sworn to before me this 26th day of FEBRUARY , 2013		
My commission expires 01/13/14		

Notary Public

I verify under oath that I have exercised due diligence in attempting to locate the current operator of record according to OCC records, who has abandoned the above well/lease and cannot be located to obtain signature. I have attached a copy of the certified recorded assignment of lease.

Signature

Signed and sworn to before me this _____ day of _____

Notary Public

My commission expires: _____

FOR OCC USE ONLY

Surety Dept. ☒ Approved ☐ RejectedDate **FEB 26 2013**Well Records Dept. ☒ Approved ☐ Rejected

FEB 27 2013
WELL RECORDS
APPROVED

NOTE: By processing this Form 1073, the Oklahoma Corporation Commission has approved the contents thereof as to form only. Oklahoma Corporation Commission does not warrant that the facts provided by the operator are true. **Form is not approved until approved by Well Records.**