

Instructions

- Please type or print using black ink.
- Form must be signed by former operator and new operator.
- Outline boundaries of lease and spot well being transferred.
- Attach 1002A for well.
- Questions should be directed to Well Records (405) 521-2275.

OKLAHOMA CORPORATION COMMISSION

Oil & Gas Conservation Division
Post Office Box 52000
Oklahoma City, OK 73152-2000

2-25-13

Form 1073
Rev. 2001

Transfer of Operator
OAC 165:10-1-15

API No. 3 5 0 7 3 2 2 5 2 2		OTC Prod. Unit No.	
Location 1/4 N 1/2 SE 1/4 SW 1/4		Sec. 3 5	Twp. 1 5 N
Ft FSL of Qtr Sec 990		Ft FWL of Qtr Sec 1980	County Kingfisher
Current Well Name/No. Mueggensborg 1C			
Original Well Name/No.			
Unit Name (if applicable)			

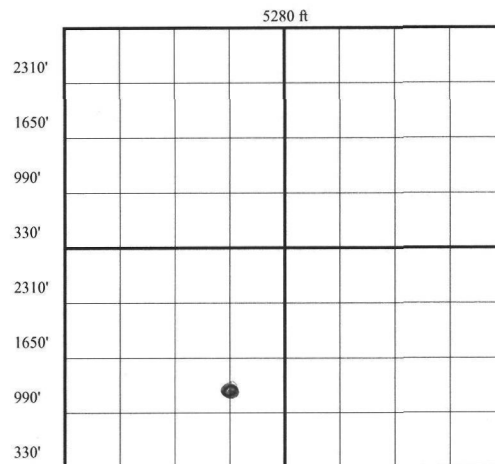

Locate Well On Grid Above

Well Class: ☐ Oil ☒ Gas ☐ Dry ☐ Plugged

Producing formation(s)	
Oil Transporter/Purchaser	OTC No.
Gas Measurer	OTC No.

The effective date of transfer of this well for the purposes of Commission records, is the date the transfer is approved by the Commission.

CURRENT OPERATOR

Name Jenex Petroleum Corporation		OCC No. 2 3 0 7 6
Address 9 5 9 5 Six Pines Drive Suite 8210		
City The Woodlands	State TX	Zip 7 7 3 8 0
Phone No. 7 1 3 - 6 2 3 - 1 6 4 4	FAX No. 8 3 2 - 4 3 6 - 1 6 8 4	
I verify that I am the legal operator of record with authority to transfer operatorship of this well.		
Signature 		
Brett Jensen, President Jenex Petroleum Company		
Name & Title (Typed or Printed)		
Signed and sworn to before me this <u>6</u> day of <u>February</u> 2013		

NEW OPERATOR

Name JEC Operating, L.L.C.		OCC No. 2 0 9 1 1
Address 921 E. Britton Rd.		
City Oklahoma City	State OK	Zip 7 3 1 1 4
Phone No. 4 0 5 - 7 5 3 - 4 4 9 2	FAX No.	
Being the new operator, as of the effective date and time of transfer accept the facts presented as being true and correct and accept the operational responsibility for the well on the described property.		
Signature 		
Russell V. Johnson, III, Manager		
Name & Title (Typed or Printed)		
Signed and sworn to before me this <u>6</u> day of <u>FEBRUARY</u> 2013		

I verify under oath that I have exercised due diligence in attempting to locate the current operator of record according to OCC records, who has abandoned the above well/lease and cannot be located to obtain signature. I have attached a copy of the certified recorded assignment of lease.

Signature

Signed and sworn to before me this _____ day of _____

My commission expires: _____

Notary Public

FEB 27 2013

FOR OCC USE ONLY

Surety Dept. ☒ Approved ☐ Rejected Date FEB 26 2013

Well Records Dept. ☒ Approved ☐ Rejected Date APPROVED

NOTE: By processing this Form 1073, the Oklahoma Corporation Commission has approved the contents thereof as to form only. Oklahoma Corporation Commission does not warrant that the facts provided by the operator are true. Form is not approved until approved by Well Records.