

MUST BE FILED BY OPERATOR OR WORKING INTEREST OWNER
 OPERATOR

OKLAHOMA CORPORATION COMMISSION
 Oil & Gas Conservation Division
 Post Office Box 52000
 Oklahoma City, Oklahoma 73152-2000

NEW WELL
 EXISTING WELL

Form 1534
 Rev. 2007

WORKING INTEREST OWNER

APPLICATION FOR TAX REBATE

APPLICANT

Applicant Name CHESAPEAKE OPERATING, INC.		Phone (405) 935-1419
Address P.O. BOX 18496		Fax No. (405) 849-1419
City OKLAHOMA CITY	State OKLAHOMA	Zip 73154-0496
Operator Name CHESAPEAKE OPERATING, INC.		OCC/ OTC No. 17441
Address P.O. BOX 18496		Phone (405) 935-1419
City OKLAHOMA CITY	State OKLAHOMA	Zip 73154-0496
Lease Name/No. PLUMMER 1-33	OTC Prod Unit No. 009-078122	API No. 35-009-20468-0003
Location (1/4 1/4 1/4) N2 S2 N2 SW	Sec. 33	Twp. 11N
	Rge. 24W	County BECKHAM

Please attach copy of 1002A.
 Additional geologic and/or engineering data may be required in order to approve any application.

I. PRODUCTION ENHANCEMENT PROJECT 165:10-21-21 through 24

Project Start Date (MM/DD/YR)	Project Completion Date (MM/DD/YR)	Orig. 1st Prod Date (MM/DD/YR)
Project description:		1st Sale Date (MM/DD/YR)
		Base Prod Amt



II. INACTIVE WELL 165:10-21-35 through 38

Cessation of production (MM/DD/YR)	3/31/2010	<input checked="" type="checkbox"/> Shut In	<input type="checkbox"/> Mechanical Failure
Re-work commenced (MM/DD/YR)	1/24/2011	Describe nature of failure: Hole in casing @ 11,696	
Production Re-established (MM/DD/YR)	4/15/2011	Describe work done to restore production to inactive well: WORKOVER/SQUEEZE/REPAIRED CASING	

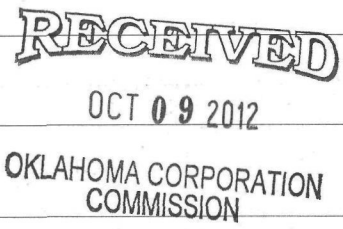

III. DEEP WELL 165:10-21-45

Total Depth	Spud Date	1st Sales Date

IV. NEW DISCOVERY 165:10-21-55 through 58

Formation	Depth (top)	Producing Interval (top-bottom)	Spud Date (MM/DD/YR)	Base Prod Amount if applicable
<input type="checkbox"/> Oil Production (>1 mile) same formation	<input type="checkbox"/> Oil Production (>1 mile) same interval of same formation	<input type="checkbox"/> Oil Production (>1 mile) deeper formation		
<input type="checkbox"/> Gas Production (>2 miles) same formation	<input type="checkbox"/> Gas Production (>2 miles) same interval of same formation	<input type="checkbox"/> Gas Production (>2 miles) deeper formation		

Attach a location plat locating and identifying the subject well and all wells within 1 mile for oil production or 2 miles for gas production.
 Attach supporting documentation for the specific "New Discovery" category.

V. HORIZONTALLY DRILLED WELL 165:10-21-65 through 69

Project Beginning Date (MM/DD/YR)	1st Prod Date (MM/DD/YR)	Measured depth at 70°	Measured depth at terminus
Base Production amount if applicable:			

VI. 3D SEISMIC AREA 165:10-21-82

Spud Date (MM/DD/YR)	First Sale Date (MM/DD/YR)	Shoot Name	3D Shoot Date (MM/DD/YR)

Attach 3D shoot project outline and evidence supporting use of 3D technology.

Affidavit Statement:

I declare that I have knowledge of the contents of the application, which was prepared by me or under my supervision and direction, with the data and facts stated herein to be true, correct, and complete to the best of my knowledge and belief.

Signature <i>E. Smith</i>	Date 09/20/2012	Phone No. (405) 935-2154
Name & Title (Typed or Printed) ELIZABETH SMITH, SR. COORDINATOR	E-mail Address ELIZABETH.A.SMITH@CHK.COM	

OCC USE ONLY

Reviewed by <i>R 1/20/13</i>	<input checked="" type="checkbox"/> Approved	<input type="checkbox"/> Denied	CHK PROP # 198729
---------------------------------	--	---------------------------------	-----------------------------



Chesapeake Energy Corporation

CST Production Monitor Export

PLUMMER 1-33

1/2008 - 8/2012 | Gross Volumes | Operated and Non-Operated Wells | 14.65 Pressure Base

Date	Gas Prod (Mcf)	Gas Sales (Mcf)	Gas Lift (Mcf)	Gas Forecast (Mcf)	Gas Goal (Mcf)	Oil Prod (bbl)	Oil Sales (bbl)	Oil Stock (bbl)	Oil Forecast (bbl)	Oil Goal (bbl)	Water Prod (bbl)	Water Inj (bbl)	Casing (psig)	Tubing (psig)	Line (psig)	Downtime (days)	Downtime Reason	Comments	Choke	Producing Well Count
01/01/2008	4,407	4,407	0	4,365	0	0	0	100	0	0	0	0	0	0	0	0			0	1
02/01/2008	2,987	2,987	0	4,256	0	0	0	100	0	0	89	0	0	0	0	0			0	1
03/01/2008	3,470	3,470	0	4,151	0	0	0	100	0	0	17	0	0	0	0	0			0	1
04/01/2008	3,458	3,458	0	4,050	0	0	0	100	0	0	3	0	0	0	0	0			0	1
05/01/2008	3,750	3,750	0	3,953	0	0	0	100	0	0	8	0	0	0	0	0			0	1
06/01/2008	3,804	3,804	0	3,859	0	0	0	100	0	0	17	0	0	0	0	0			0	1
07/01/2008	3,558	3,558	0	3,768	0	0	0	100	0	0	73	0	0	0	0	0			0	1
08/01/2008	3,710	3,710	0	3,681	0	0	0	100	0	0	32	0	0	0	0	0			0	1
09/01/2008	2,692	2,692	0	3,597	0	0	0	100	0	0	67	0	0	0	0	0			0	1
10/01/2008	3,192	3,192	0	3,174	0	0	0	100	0	0	32	0	0	0	0	0			0	1
11/01/2008	2,961	2,961	0	3,103	0	0	0	100	0	0	8	0	0	0	0	0			0	1
12/01/2008	1,898	1,898	0	3,034	0	0	0	100	0	0	122	0	0	0	0	0			0	1
01/01/2009	670	670	0	2,968	0	0	0	100	0	0	0	0	0	0	0	0			0	1
02/01/2009	790	790	0	2,904	0	0	0	100	0	0	12	0	0	0	0	0			0	1
03/01/2009	1,127	1,127	0	2,842	0	0	0	100	0	0	0	0	0	0	0	3	Pressure Buildup		0	1
04/01/2009	812	812	0	2,782	0	0	0	100	0	0	0	0	0	0	0	0			0	1
05/01/2009	335	335	0	2,724	0	0	0	100	0	0	0	0	0	0	0	0			0	1
06/01/2009	205	205	0	2,668	0	0	0	100	0	0	0	0	0	0	0	0			0	1
07/01/2009	275	275	0	2,613	0	0	0	100	0	0	0	0	0	0	0	0			0	1
08/01/2009	138	138	0	2,485	0	0	0	100	0	0	3	0	0	0	0	0			0	1
09/01/2009	1,310	1,310	0	2,425	0	0	0	100	0	0	43	0	0	0	0	0			0	1
10/01/2009	650	650	0	388	0	0	0	100	0	0	0	0	0	0	0	0			0	1
11/01/2009	336	336	0	378	0	0	0	100	0	0	0	0	0	0	0	1	Pressure Buildup		0	1
12/01/2009	160	160	0	370	0	0	0	100	0	0	0	0	0	0	0	0			0	1
01/01/2010	289	289	0	210	0	0	0	100	0	0	0	0	0	0	0	0			0	1
02/01/2010	166	166	0	206	0	0	0	100	0	0	0	0	0	0	0	2	Pressure Buildup		0	1
03/01/2010	148	148	0	201	0	0	0	100	0	0	0	0	0	0	0	1	Shut-in		0	1
04/01/2010	0	0	0	196	0	0	0	100	0	0	0	0	0	0	0	30	Shut-in		0	0
05/01/2010	0	0	0	192	0	0	0	100	0	0	0	0	0	0	0	31	Shut-in		0	0
06/01/2010	0	0	0	188	0	0	0	100	0	0	0	0	0	0	0	30	Shut-in		0	0
07/01/2010	0	0	0	184	0	0	0	100	0	0	0	0	0	0	0	31	Shut-in		0	0
08/01/2010	0	0	0	180	0	0	0	100	0	0	0	0	0	0	0	31	Shut-in		0	0
09/01/2010	0	0	0	176	0	0	0	100	0	0	0	0	0	0	0	30	Shut-in		0	0
10/01/2010	0	0	0	172	0	0	0	100	0	0	0	0	0	0	0	31	Shut-in		0	0
11/01/2010	0	0	0	169	0	0	0	100	0	0	0	0	0	0	0	30	Shut-in		0	0
12/01/2010	0	0	0	165	0	0	0	100	0	0	0	0	0	0	0	31	Shut-in		0	0
01/01/2011	0	0	0	162	0	0	0	100	0	0	0	0	0	0	0	31	Workover		0	0
02/01/2011	0	0	0	159	0	0	0	100	0	0	0	0	0	0	0	28	Workover		0	0
03/01/2011	0	0	0	156	0	0	0	100	0	0	0	0	0	0	0	31	Frac Job		0	0
04/01/2011	7,360	7,360	0	153	0	0	0	100	0	0	3,374	0	0	0	0	15	Compressor Down		0	0
05/01/2011	7,986	7,986	0	13,419	0	32	0	100	0	0	4,222	0	0	0	0	4	High Line Pressure		0	1
06/01/2011	3,633	3,633	0	10,799	0	66	0	133	0	0	2,237	0	0	0	0	0			0	1
07/01/2011	5,607	5,607	0	9,066	0	94	173	199	0	0	5,037	0	0	0	0	0			0	1
08/01/2011	7,051	7,051	185	7,830	0	10	0	120	0	0	5,671	0	0	0	0	0			0	1
09/01/2011	6,365	6,365	169	6,903	0	134	183	130	0	0	4,170	0	0	0	0	0			0	1
10/01/2011	4,924	4,924	218	6,179	0	50	0	81	0	0	3,764	0	0	0	0	1	Compressor Down		0	1
11/01/2011	3,380	3,380	729	5,599	0	46	0	131	0	0	2,030	0	0	0	0	7	Safety		0	1

Operated Daily Activity Report

NORTHERN
ANADARKO

2/7/2011	0'	\$18,640	SET CEMENT RETAINER.
	0'	\$300,026	SICP 0MIRU WIRELINE, RIH WITH 7.9 GR/CCL TO 13780 WLM, PERFORATE SQUEEZE HOLES AT 12875 TO 12877' 4 SPF, 8 HOLES. PU, RIH WITH CEMENT RETAINER, SET AT 12775', PU STINGER, RIH WITH 240 JOINTS, SDFN.
2/8/2011	0'	\$35,739	BREAK DOWN AND SQUEEZE
	0'	\$335,765	SICP 0FINISH TIH WITH CEMENT RETAINER STINGER, STING IN AT 12775'. ESTABLISH INJECTION RATE WITH 50 BBLs 2% AT 1.5 BPM AT 3000 PSI, IN SQUEEZE HOLES AT 12875'. PUMP 10 BBL FW SPACER, 21 BBL (100 SXS) CLASH H CEMENT WITH RETARDER, 10 BBL FW, 63 BBL DISPLACEMENT, LEAVING .8 BBL IN TUBING, STING OUT, REVERSE CIRCULATE WITH 100 BBL 2%. POOH WITH 10 STANDS, SDFN. PICKEL TREE. MAX RATE; 1.5 BPM, MAX PRESSURE 2760.
2/9/2011	0'	\$2,680	SHUT DOWN OPERATIONS
	0'	\$338,445	SICP 0SHUT DOWN DUE TO WEATHER. RESUME OP'S FRIDAY, WEATHER PERMITING.
2/10/2011	0'	\$3,680	SHUT DN OPS
	0'	\$342,125	SITP 0# SICP 0#SHUT DN DUE TO WEATHERTHIS AM SITP 0# SICP 0# WILL TOOH W/ TBG, TIH TBG & PACKER
2/11/2011	0'	\$12,965	TOOH W/ TBG, TIH W/ TBG & PACKER
	0'	\$355,090	SITP 0# SICP 0# HELD SAFETY MTG, TOOH W/ TBG & STINGER, TIH W/ 9-5/8" RTTS PACKER, SSN, 361 JNTS TBG. SET PACKER @ 11550' (119' ABOVE HOLE IN CSG) W/ 20K COMPRESSION. TEST CSG TO 1000#, HELD. ESTABLISH INJECTION RATE W/ 65 BBLs: 2% TKCL 1.5 B/M @ 2550#. PUMPED METHANOL IN BOP. SWI, SDFN.THIS AM SITP 550# SICP 625# SQUEEZE HOLE IN CSG
2/12/2011	0'	\$31,248	<u>SQUEEZE HOLE IN CSG</u>
	0'	\$386,338	SITP 550# SICP 625#HELD SAFETY MTG, MIRU CEMENTERS, TEST IRON TO 3500#, LED SLURRY W/ 10 BBLs FRESH WATER, PUMPED 100 SKS 15.6 PPG CLASS H CMT (21 BBL SLURRY, YIELD: 1.18), DISPLACE W/ 69 BBL FRESH WATER (2 BBL BELOW PKR), SHUT DN & STAGE CMT 6 TIMES, DISPLACED WITH ADDITIONAL 5.2 BBL FRESH WATER (CMT 0.8 BBL FROM HOLE), PRESSURE INCREASED TO 2300# @ 0.5 BPM, BLED OFF PRES, CMT REMAINED. RELEASE PKR AND REVERSE OUT W/ 90 BBLs, RECOVERED NO CMT, TOOH W/ 21 JTS, PRESSURE TBG TO 2300#, SWI, SDFNTHIS AM SITP 550# SICP 480# WILL TOOH W/ TBG & PKR, TIH W/ BIT & COLLARS
2/13/2011	0'	\$6,805	ESTABLISH INJECTION RATE
	0'	\$393,143	SITP 550# SICP 480# HELD SAFETY MTG, TIH W/ 20 JNTS, SET PACKER @ 11519' (150' ABOVE HOLE IN CSG) W/ 20K COMPRESSION. RU PUMP TO TBG, BROKE @ 0.25 B/M @ 2550#, ESTABLISH INJECTION RATE W/ 56 BBLs: 2% TKCL: 1.6 B/M @ 3000#. SWI, SDFN.THIS AM SITP 420# SICP 600# SQUEEZE HOLE IN CSG
2/14/2011	0'	\$18,936	<u>SQUEEZE HOLE AT 11696</u>
	0'	\$412,079	SITP 0 SICP 0SAFETY MEETING. MIRU SUPERIOR WELL SERVICE. ESTABLISH INJECTION RATE, 1.5 BPM AT 2500 WITH 10 BBL FRESH WATER, MIX AND PUMP 100 SXS 15.6 LB, CLASS H CEMENT WITH RETARDER, 2 1/2 HOUR PUMP TIME. DISPLACE WITH 10 BBL FRESH WATER SPACER AND 62 BBL TREATED 2% KCL. PRESSURED UP TO 3000 PSI BLEED OFF TO ZERO, NO FLOW BACK, RELEASE PACKER, REVERSE OUT WITH 100 BBLs, POOH WITH 10 STANDS TO 10886, SET PACKER, PRESSURE TO 2500. SDFN WOC, WITH 2050 ON TUBING. PRESSURE THIS AM; SITP 900 PSI, SICP 0
2/15/2011	0'	\$14,062	TOOH, INSPECT A SECTION
	0'	\$426,141	SITP 900 SICO 0RELEASE PACKER, POOH. MIRU AIR COMPRESSOR AND IMPACT WRENCH. REMOVE BOP, INSPECT BOWL. POLISH ID OF BOWL, CLEAN PIN THREADS, REPLACE PACKING GLANDS AND PINS. NU BOP, PU BIT, BIT SUB, 10 4 1/8" DC'S, 1 JT, SN. TIH WITH 45 STANDS. EOT AT 3205'. LOAD WELL WITH 14 BBL APPLY 500 PSI. SDFN.PRESSURE THIS AM; SITP 380, SICP 380
2/16/2011	0'	\$15,315	TEST CSG, DRILL CEM'T AND RETAINER
	0'	\$441,456	SITP 380, SICP 380JSA, CONTINUE IN HOLE WITH DRILL BIT. TAG CEMENT AT 11580' PU TEST CASING TO 3000 PSI, HELD 5 MINUTES, TEST GOOD, ENGAGE CEMENT, DRILL 89' CEMENT TO SQUEEZED HOLE. PRESSURE TEST TO 3000 PSI, LOST 750 LBS TO 2250 PSI IN 25 MINUTES. TIH TAG CEMENT AT 12707', DRILL 68' CEMENT, START DRILLING ON CEMENT RETAINER AT 12775'. DRILL ON RETAINER 3 HOURS, MAKE 6" HOLE. CIRCULATE CLEAN, POOH WITH 20 STANDS TO 11491'. APPLY 1000 LBS TO WELL. SCURE WELL, SDFN.PRESSURE THIS AM; SITP 800, SICP 800.

PLEASE TYPE OR USE BLOCK LETTERS

Form 1002A
Rev 1979

(To be filed within 30 days after drilling is completed)
OKLAHOMA CORPORATION COMMISSION
OIL AND GAS CONSERVATION DIVISION

OTC COUNTY
LEASE NO

Jim Thorpe Building / Oklahoma City, Oklahoma 73105

API NO
00920468

COUNTY Beckham SEC 33 TWP 11N RGE 24W

COMPANY OPERATING ANR Production Company

OFFICE ADDRESS 1400 Fidelity Plaza

TOWN Oklahoma City STATE Ok. ZIP 73102

FARM NAME Plummer WELL NO 1-33

DRILLING STARTED 10-1-81 DRILLING FINISHED 7-21-82

DATE OF FIRST PRODUCTION 9-8-82 COMPLETED 9-8-82

WELL LOCATED C SW

1700' FT FROM SL OF 1/4 SEC & 1320 FT FROM WL OF 1/4 SEC

ELEVATION DERRICK FLOOR 2069 GROUND 2039

COMPLETION & TEST DATA BY PRODUCING FORMATION

	1	2	3
FORMATION	Morrow		
SPACING & SPACING ORDER NO.	640	134749	
CLASSIFICATION (Oil; Gas; Dry; Inj. Well)	Gas		
PERFORATED	18366-18376		
	18237-18247		
INTERVALS			
13963			
ACIDIZED?	No		
FRACTURE TREATED?	No		

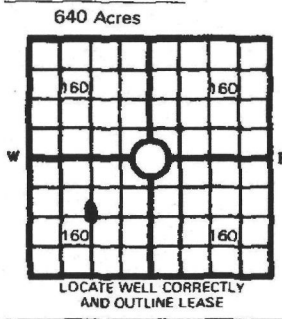

TYPE COMPLETION
Single Zone X Order No. 134749
Multiple Zone _____ Order No. _____
Commingled _____ Order No. _____

LOCATION EXCEPTION Order No. _____ Penalty _____

OIL OR GAS ZONES

Name	From	To	Name	From	To
Morrow	18237	18376			

CASING & CEMENT

Casing Set			Csg Test		Cement		
Size	Wgt	Grade	Feet	Psi	Sax	Fillup	Top
20"	94#	K-55	205	250	500	205	Surf.
9-5/8"	53.50#	LT&C	14192	2500	1695	2116	12076
13-3/8"	68#	J-55	4484	350	1850	4484	Surf.
5-1/2"	23#	P110	17393	2500	100	100	12076
5"	23#	P110	1658	Lnr.			

TOTAL DEPTH 19066'
PBTD 19007'

PACKERS SET
Depth 17399'
BOT PBR
Make _____

INITIAL TEST DATA

Date	9-8-82		
Oil-bbl./day	-		
Oil Gravity	-		
Gas-Cu. Ft./day	3409	CF	CF
Gas-Oil Ratio Cu. Ft./Bbl.	-		
Water-Bbl./day	12		
Pumping or flowing	Flowing		
CHOKE SIZE	7/64		
FLOW TUBING PRESSURE	8100		

A record of the formations drilled through, and pertinent remarks are presented on the reverse

(OVER)

I, the undersigned, being first duly sworn upon oath, state that this well record is true, correct and complete according to the records of the office and the best of my knowledge and belief.

Telephone 405-239-7031 Bob Davidson-Dist. Engineering & Prod.
Name and title of representative of company Mgr.

Subscribed and sworn before me this 28th day of September, 19 82

My commission expires May 27, 1985
May B. Poynter
Notary Public

(OVER)

SUBMITTING
COMPANY
NAME

Chesapeake Operating

NUMBER OF
APPLICATIONS

29

DATE
RECEIVED

CHECK RECEIPT #

RECEIVED

OCT 09 2012

OKLAHOMA CORPORATION
COMMISSION

OKLA CORP COM
RECEIPT 130246049
Date: 10/15/2012 Time: 10:09
Case: 00000000 Cashier: YMS
Payor: CHESAPEAKE OPERATING
Check: 1833813 \$2,900.00
56 TAX EXEMPTION APP