

# RECEIVED

JAN 06 2012

## COMPLETION REPORT OKLAHOMA CORPORATION COMMISSION

Form 1002A  
Rev. 1996

API NO. **35 053 22882**

OTC PROD. UNIT NO.

Rule 165:10-3-25  
ORIGINAL  
 AMENDED  
Reason Amended \_\_\_\_\_

Oil & Gas Conservation Division  
Post Office Box 52000-2000  
Oklahoma City, Oklahoma 73152-2000

**359MSSP**  
COMPLETION & TEST DATA BY PRODUCING FORMATION

PLEASE TYPE OR USE BLACK INK ONLY

NOTE: Attach copy of original 1002A if recompletion or reentry

TYPE OF DRILLING OPERATION

STRAIGHT HOLE  DIRECTIONAL HOLE  HORIZONTAL HOLE

If directional or horizontal, see reverse for bottom hole location.

COUNTY	Grant	SEC	23	TWP	26N	RGE	7W
LEASE NAME	Tom			WELL NO.	23-1H		
SHL	S2 1/4	S2 1/4	SE 1/4	SW 1/4	225 FSL	1980	FWL OF 1/4 SEC
ELEVATION	Derrick FI Ground 1066			SPUD DATE	9/3/11		
DRLG FINISHED	9/28/11			WELL COMPLETION	11/16/11		
1ST PROD DATE	11/24/11			RECOMP DATE			

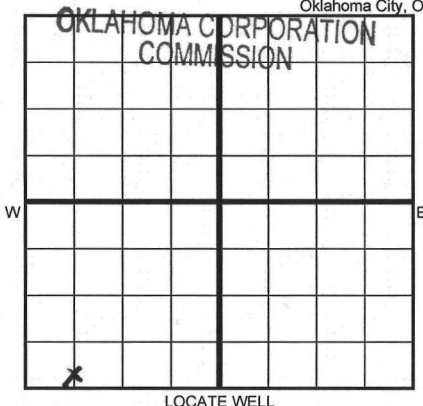

FORMATION	Mississippi an	
SPACING & SPACING ORDER NUMBER	588048	
CLASS: Oil, Gas, Dry, Inj, Disp, Comm Disp	Gas	
PERFORATED INTERVALS	6,100	
	9,575	
ACID/VOLUME	55,772 BBLS	Water
Fracture Treated?	1,011,119 30/50	Jordan Inman Sand
Fluids Amounts		

OPERATOR NAME	Panther Energy Company, LLC	OTC/OCC OPERATOR NO.	21717-0
ADDRESS	P. O. Box 3105		
CITY	Tulsa	STATE	OK
		ZIP	74101

<input checked="" type="checkbox"/> SINGLE ZONE
<input type="checkbox"/> MULTIPLE ZONE ORDER NO.
<input type="checkbox"/> COMMINGLED ORDER NO.
<input type="checkbox"/> LOCATION EXCEPTION ORDER NO.
<input type="checkbox"/> INCREASED DENSITY ORDER NO.
<input type="checkbox"/> PENALTY

OIL OR GAS ZONES FORMATIONS	TOP	BOTTOM

CASING & CEMENT (Form 1002C must be attached)	TYPE	SIZE	WEIGHT	GRADE	FEET	PSI	SAX	FILLUP	TOP
Conductor									
Surface	9 5/8"	36	J55	250		240			surface
Intermediate	7"	23&26	J55	5,707		175			1,942
Production	4 1/2	11.6	P110	9,928		570			7,830
Liner									

PACKER @ \_\_\_\_\_ BRAND & TYPE \_\_\_\_\_ TOTAL DEPTH **9929**

PLUG @ \_\_\_\_\_ TYPE \_\_\_\_\_

*Per back 1002A + survey*

### INITIAL TEST DATA

INITIAL TEST DATE	11/25/11
OIL-BBL/DAY	60
OIL-GRAVITY (API)	41
GAS-MCF/DAY	1.2 MCF
GAS-OIL RATIO CU FT/BBL	16,667
WATER-BBL/DAY	2,020
PUMPING OR FLOWING	Flowing
INITIAL SHUT-IN PRESSURE	
CHOKE SIZE	24/64
FLOW TUBING PRESSURE	160

A record of the formations drilled through, and pertinent remarks are presented on the reverse. I declare that I have knowledge of the contents of this report and am authorized by my organization to make this report, which was prepared by me or under my supervision and direction, with the data and facts stated herein to be true, correct, and complete to the best of my knowledge and belief.

*Ken Campbell*

Ken Campbell

NAME (PRINT OR TYPE)

P. O. Box 3105 Tulsa OK 74101

ADDRESS CITY STATE ZIP

12/29/2011

(918) 551-7112

DATE

PHONE NUMBER

