

APPLICATION TO DRILL, RECOMPLETE OR REENTER

FORM 1000  
REV. 2014

FILE ORIGINAL ONLY  
PLEASE TYPE OR USE BLACK INK

OKLAHOMA CORPORATION COMMISSION  
OIL & GAS CONSERVATION DIVISION  
JIM THORPE BUILDING  
P.O. BOX 52000  
OKLAHOMA CITY, OK 73152-2000  
(RULE 165:10-3-1)

WALK THROUGH

1. OTC/OCC OPERATOR NUMBER  
**22183**

2. API NUMBER

3. NOTICE OF INTENT TO: (CHECK ONLY ONE)  
 DRILL  RECOMPLETE  REENTER  DEEPEN  AMEND - REASON  
NOTE: ATTACH COPY OF 1002-A IF RECOMPLETION OR REENTRY.

4. TYPE OF DRILLING OPERATION >>>>>> (NOTE: If directional or horizontal, see reverse side for bottom hole location)  
A.  STRAIGHT HOLE  DIRECTIONAL HOLE  HORIZONTAL HOLE  
B.  OIL/GAS  INJECTION  DISPOSAL  WATER SUPPLY  STRAT TEST  SERVICE WELL

6. LOCATE WELL AND OUTLINE LEASE OR SPACING UNIT IN INK.

5. WELL LOCATION:

SECTION	11	TOWNSHIP	01N	RANGE	20W	COUNTY	Jackson
SPOT LOCATION:							
1/4 SW 1/4		1/4 NE 1/4		1/4 NW 1/4		FEET FROM QUARTER from SOUTH LINE from WEST LINE	
						SECTION LINES: 1650 1650	

7. Well will be **990** feet from nearest unit or property boundary.

8. LEASE NAME: **Walls** WELL NUMBER: **8**

9. NAME OF OPERATOR: **Fulcrum Exploration, LLC** EMAIL ADDRESS:

ADDRESS **3700 River Walk Drive, Suite 175** PHONE (AC/NUMBER) **214-513-7610**

CITY STATE ZIP CODE

10. SURFACE OWNER (ONE ONLY, ATTACH SHEET FOR ADDITIONAL OWNERS)  
**Marc Walls**

ADDRESS **11425 Warwick Place Drive**

CITY **Oklahoma City** STATE **OK** ZIP CODE **73162**

11. Is well located on lands under federal jurisdiction?  Y  N

12. Will a water well be drilled?  Y  N  
Will surface water be used?  Y  N

13. Date Operation to Begin **02/15/18**

14. LIST TARGET FORMATIONS AND DEPTHS OF EACH BELOW (LIMITED TO TEN)

1) Permian 1400'	6)
2) Cisco 1550'	7)
3)	8)
4)	9)
5)	10)

15. SPACING ORDER NUMBER(S) AND SIZE UNIT(S):

16. PENDING APPLICATION C.D. NO.

17. LOCATION EXCEPTION ORDER NO.

18. INCREASED DENSITY ORDER NO.

19. TOTAL DEPTH **1800'** 20. GROUND ELEV. **1313'** 21. BASE OF TREATABLE WATER **210'** 22. SURFACE CASING **260'** 23. ALT CASING PROG USED?  Y  N

24. ALTERNATIVE CASING PROCEDURE, check box and fill in blank (AFFIDAVIT REQUIRED, see reverse side, line 31.)  
 A. Cement will be circulated from total depth to ground surface on the production casing string.  
 B. Cement will be circulated from \_\_\_\_\_ depth to \_\_\_\_\_ depth by use of a two stage cementing tool.

25.1. PIT INFORMATION: Using more than one pit or mud system?  Y  N If yes, fill out line 25.2 on top reverse side.

A. TYPE OF MUD SYSTEM:  WATER BASED  OIL BASED  GAS BASED (AIR DRILL)

B. EXPECTED MUD CHLORIDE CONTENT: maximum: **5000** ppm; average: **3000** ppm.

PIT #1 C. TYPE OF PIT SYSTEM:  on-site  off-site  closed If off-site, specify location: \_\_\_\_\_

D. IS DEPTH TO TOP OF GROUND WATER GREATER THAN 10 FT BELOW BASE OF PIT?  Y  N

E. WITHIN 1 MILE OF MUNICIPAL WATER WELL?  Y  N Off-Site Pit No. \_\_\_\_\_

F. WELLHEAD PROTECTION AREA?  Y  N

26.1. A. CATEGORY 1A 1B 2 3 4 C

OCC USE ONLY B. PIT LOCATION:  Alluvial Plain  Terrace Deposit  Bedrock Aquifer  Other H.S.A.  Non-H.S.A. Fm: \_\_\_\_\_

C. Special area or field rule? \_\_\_\_\_ D. DEEP SCA?  Y  N E. CBL required?  Y  N

F. SOIL COMPACTED LINER REQUIRED?  Y  N G. 20 mil GEOMEMBRANE LINER REQUIRED?  Y  N

27. PROPOSED METHOD FOR DISPOSAL OF DRILLING FLUIDS (MUST BE COMPLETED)

A. Evaporation/dewater and backfilling of reserve pit.

B. Public Landfill: Location \_\_\_\_\_

C. Annular Injection (REQUIRES PERMIT and surface casing set 200 feet below base of treatable water-bearing formation.) PERMIT NO. \_\_\_\_\_

D. One time land application (REQUIRES PERMIT) PERMIT NO. \_\_\_\_\_

E. Haul to Commercial pit facility; Specify site: \_\_\_\_\_ Order No. \_\_\_\_\_

F. Haul to Commercial soil farming facility; Specify site: \_\_\_\_\_ Order No. \_\_\_\_\_

G. Haul to recycling/re-use facility; Specify site: \_\_\_\_\_ Order No. \_\_\_\_\_

H. Other, Specify: \_\_\_\_\_

I hereby certify I am authorized to submit this two page application prepared by me or under my supervision.  
The facts and proposals made herein are true, correct and complete to the best of my knowledge and belief.

SIGNATURE *Heidi Carbo* NAME (Print or Type) **Heidi Carbo** PHONE (AC/NO.) **214-513-7610** FAX (AC/NO.) **972-874-2415** DATE **02/01/18**

NOTICE: Approval is void if operations have not commenced within six months of the date of approval. An approved permit must be posted at the location during drilling and completion operations. File the Form 1001A, Spud Report, within fourteen days of commencement of operations.

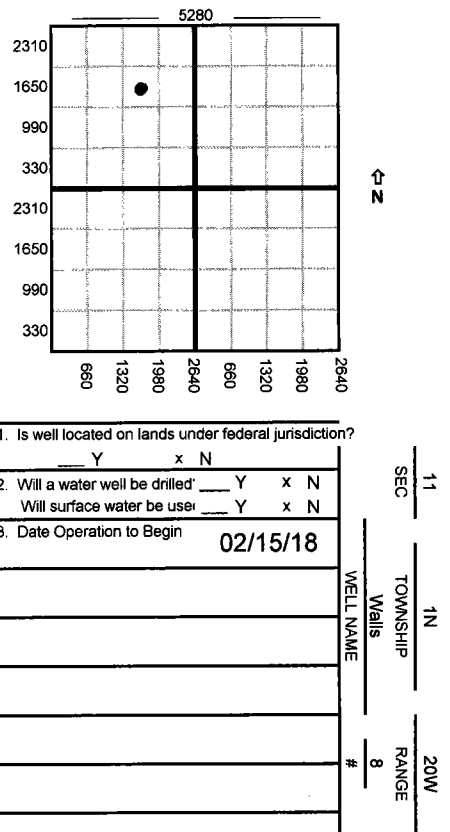

**NOTIFY DISTRICT OFFICE 24 HOURS PRIOR TO CEMENTING SURFACE CASING.**

**25.2. PIT INFORMATION:**

A. TYPE OF MUD SYSTEM:  WATER BASED  OIL BASED  GAS BASED (AIR DRILL)  
 B. EXPECTED MUD CHLORIDE CONTENT: maximum: \_\_\_\_\_ ppm; average: \_\_\_\_\_ ppm.  
**PIT #2** C. TYPE OF PIT SYSTEM:  on-site  off-site  closed If off-site, specify location: \_\_\_\_\_  
 D. IS DEPTH TO TOP OF GROUND WATER GREATER THAN 10 FT BELOW BASE OF PIT?  Y  N  
 E. WITHIN 1 MILE OF MUNICIPAL WATER WELL?  Y  N Off-Site Pit No. \_\_\_\_\_  
 F. WELLHEAD PROTECTION AREA?  Y  N

**26.2 OCC USE ONLY** A. CATEGORY 1A 1B 2 3 4 C Fm: \_\_\_\_\_  
 B. PIT LOCATION:  Alluvial Plain  Terrace Deposit  Bedrock Aquifer  Other H.S.A.  Non-H.S.A.  
 C. Special area or field rule?  D. DEEP SCA?  Y  N E. CBL?  Y  N  
 F. SOIL COMPACTED LINER REQUIRED?  Y  N G. 20 mil GEOMEMBRANE LINER REQUIRED  Y  N

**29** Bottom Hole Location SEC \_\_\_\_\_ TWP \_\_\_\_\_ RGE \_\_\_\_\_ COUNTY \_\_\_\_\_  
 for Directional Hole:  
 SPOT LOCATION: 1/4 \_\_\_\_\_ 1/4 \_\_\_\_\_ 1/4 \_\_\_\_\_ FEET FROM QUARTER from SOUTH LINE from WEST LINE  
 SECTION LINES:  
 Measured Total True Vertical BHL from nearest Lease, Unit, Or Property Line:  
 Depth Depth

**30.** Bottom Hole Location for Horizontal Hole: (LATERALS)

**LATERAL #1:** SEC \_\_\_\_\_ TWP \_\_\_\_\_ RGE \_\_\_\_\_ COUNTY \_\_\_\_\_  
 SPOT LOCATION: 1/4 \_\_\_\_\_ 1/4 \_\_\_\_\_ 1/4 \_\_\_\_\_ FEET FROM QUARTER from SOUTH LINE from WEST LINE  
 SECTION LINES:  
 Depth of Deviation Radius of Turn Direction Total Length  
 Measured Total True Vertical End Point location from nearest lease, unit  
 Depth Depth or property line:

**LATERAL #2:** SEC \_\_\_\_\_ TWP \_\_\_\_\_ RGE \_\_\_\_\_ COUNTY \_\_\_\_\_  
 SPOT LOCATION: 1/4 \_\_\_\_\_ 1/4 \_\_\_\_\_ 1/4 \_\_\_\_\_ FEET FROM QUARTER from SOUTH LINE from WEST LINE  
 SECTION LINES:  
 Depth of Deviation Radius of Turn Direction Total Length  
 Measured Total True Vertical End Point location from nearest lease, unit  
 Depth Depth or property line:

**LATERAL #3:** SEC \_\_\_\_\_ TWP \_\_\_\_\_ RGE \_\_\_\_\_ COUNTY \_\_\_\_\_  
 SPOT LOCATION: 1/4 \_\_\_\_\_ 1/4 \_\_\_\_\_ 1/4 \_\_\_\_\_ FEET FROM QUARTER from SOUTH LINE from WEST LINE  
 SECTION LINES:  
 Depth of Deviation Radius of Turn Direction Total Length  
 Measured Total True Vertical End Point location from nearest lease, unit  
 Depth Depth or property line:

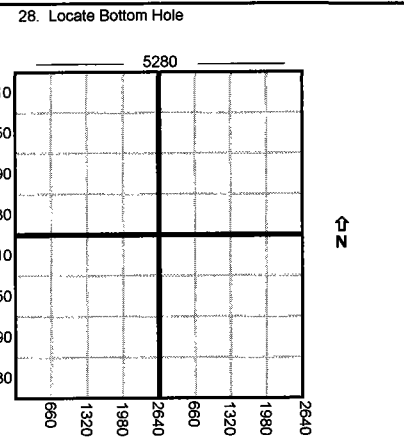

1. If more than two drainholes are proposed, attach separate sheet indicating the necessary information.
2. Direction must be stated in degrees azimuth.
3. Please note the horizontal drainhole and its end point must be located within the legal boundaries of the lease or spacing unit. Directional surveys are required for all drainholes and directional wells.

**31. AFFIDAVIT FOR ALTERNATIVE CASING PROGRAM** (Signature on front of this form attests to this affidavit)

1. This well  WILL  WILL NOT penetrate any known lost circulation zones.
2. During the drilling of this well, withdrawals from any water well within 1/4 mile  WILL  WILL NOT exceed 50 gallons per minute.
3. The projected depth of the well  IS  IS NOT less than 100 feet from the top of any enhanced recovery project or gas storage facility.
4. List the following for all water wells within 1/4 mile of this well. (Information concerning some water wells may be obtained from the OKLAHOMA WATER RESOURCES BOARD, 3800 N. Classen Blvd., Oklahoma City, OK 73118). IF NO WATER WELLS FOUND, SO STATE. (ATTACH ADDITIONAL SHEET IF NECESSARY)

Name of Owner/Operator	Address of Owner/Operator	Location (Nearest 1/4 1/4 1/4 1/4)	Depth of Well

5. A cement bond log is required to be run and submitted from not less than 100 feet below the base of the treatable water-bearing formation to the surface. **OCC USE ONLY**  
 6. If casing depth is more than 250 feet deeper than base of the treatable water-bearing formation, operator must submit a letter of request listing reasons and precautions to be taken.

**INTENT TO DRILL CHECKLIST**

APPROVED  REJECTED

**OCC USE ONLY**

1. SURETY **8/7/18**  
 A. NONE filed.  
 B. EXPIRED: Date \_\_\_\_\_  
 C. OUTSTANDING CONTEMPT ORDER.

4. GEOLOGY

**DO NOT WRITE INSIDE THIS BOX**

RECEIVED 180894007  
 OKLA CORP COMM  
 Date: 03/02/2018 Time: 08:39  
 Case: 000000000 Cashier: ESK  
 Payer: FULCROM EXPLORATION LLC  
 Check: 9252 \$500.00  
 45 Emerg Walk Thru ITB