

APT NO. **117-23346**  
 OTC PROD. UNIT NO. **117-124927**

PLEASE TYPE OR USE BLACK INK ONLY  
 NOTE:  
 Attach copy of original 1002A if recompletion or reentry.

OKLAHOMA CORPORATION COMMISSION  
 Oil & Gas Conservation Division  
 Post Office Box 52000  
 Oklahoma City, Oklahoma 73152-2000  
 Rule 165:10-3-25

Form 1002A  
 Rev. 2007

- ORIGINAL
- AMENDED
- Reason Amended \_\_\_\_\_

COMPLETION REPORT

TYPE OF DRILLING OPERATION  
 STRAIGHT HOLE  DIRECTIONAL HOLE  HORIZONTAL HOLE  
 SERVICE WELL

SPUD DATE **09/03/08**  
 DRLG FINISHED **09/28/08**  
 WELL COMPLETION **01/12/09**  
 1ST PROD DATE **01/12/09**  
 RECOMP DATE \_\_\_\_\_

903172017

If directional or horizontal, see reverse for bottom hole location.

COUNTY **Pawnee** SEC **31** TWP **22N** RGE **4E**  
 LEASE NAME **RIPLEY** WELL NO. **1H-31**  
 SHL **S 1/2 S 1/2 NE 1/4 SW 1/4** FSL **1470'** FWL **1980'**  
 ELEVATION **921'** Ground **909'** Latitude if Known **36 20'14.4 "N** Longitude if Known **96 55' 04.4" W**  
 OPERATOR NAME **Pablo Energy II, LLC** OTC/OCC OPERATOR NO. **21896-0**  
 ADDRESS **2209 W. 7th Street, Ste 403**  
 CITY **Amarillo** STATE **TX** ZIP **79106**

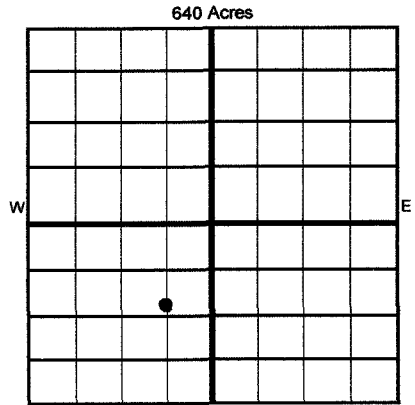

COMPLETION TYPE  
 SINGLE ZONE  
 MULTIPLE ZONE  
 COMMINGLED  
 LOCATION EXCEPTION ORDER NO. **562050**  
 INCREASED DENSITY ORDER NO. \_\_\_\_\_

CASING & CEMENT (Form 1002C must be attached)

TYPE	SIZE	WEIGHT	GRADE	FEET	PSI	SAX	TOP OF CMT
Conductor	16"			40'			Surface
Surface	9 5/8"	36#	J-55	318'		170	Surface
Intermediate	7"	23#	J-55	3861'		100	3250'
Production	4 1/2"	10.5#	J-55	7192'		300	3610' (CBL)
Liner							

PACKER @ \_\_\_\_\_ BRAND & TYPE \_\_\_\_\_ PLUG @ \_\_\_\_\_ TYPE \_\_\_\_\_ PLUG @ \_\_\_\_\_ TYPE \_\_\_\_\_ TOTAL DEPTH **7200'**  
 PACKER @ \_\_\_\_\_ BRAND & TYPE \_\_\_\_\_ PLUG @ \_\_\_\_\_ TYPE \_\_\_\_\_ PLUG @ \_\_\_\_\_ TYPE \_\_\_\_\_

COMPLETION & TEST DATA BY PRODUCING FORMATION **351 MISS**

FORMATION	SPACING & SPACING	ORDER NUMBER	CLASS: Oil, Gas, Dry, Inj, Disp, Comm Disp, Svc	PERFORATED INTERVALS	ACID/VOLUME Fracture Treatment (Fluids/Prop Amounts)
<b>Mississippi</b>	<b>640 acres</b>	<b>559657</b>	<b>OIL</b>	<b>7054' - 6800'</b> <b>5274' - 4988'</b>	<b>6692' - 6346'</b> <b>4868' - 4640'</b>
				<b>6229' - 6000'</b> <b>4491' - 4150'</b>	<b>5787' - 5500'</b>
					<b>31,800 gals 15% acid</b> <b>53,557 BW, 1,239,424#-20/40 Ottawa sd, 166,410# - 20/40 resin-coated sand.</b>

Request minimum gas allowable (165:10-17-7) Gas Purchaser/Measurer \_\_\_\_\_ 1st Sales Date \_\_\_\_\_

INITIAL TEST DATA

INITIAL TEST DATE	OIL-BBL/DAY	OIL-GRAVITY ( API)	GAS-MCF/DAY	GAS-OIL RATIO CU FT/BBL	WATER-BBL/DAY	PUMPING OR FLOWING	INITIAL SHUT-IN PRESSURE	CHOKE SIZE	FLOW TUBING PRESSURE
<b>1/20/2009</b>	<b>94</b>	<b>35</b>	<b>1</b>	<b>10.5</b>	<b>1009</b>	<b>pumping</b>	<b>0</b>		

A record of the formations drilled through, and pertinent remarks are presented on the reverse. I declare that I have knowledge of the contents of this report and am authorized by my organization to make this report, which was prepared by me or under my supervision and direction, with the data and facts stated herein to be true, correct, and complete to the best of my knowledge and belief.

SIGNATURE NAME (PRINT OR TYPE) **Gary E. Wurdeman** DATE **03/11/09** PHONE NUMBER **405-767-0785**  
 ADDRESS **519 E. Memorial, Ste C-3, Oklahoma City, OK, 73114** CITY STATE ZIP EMAIL ADDRESS

PLEASE TYPE OR USE BLACK INK ONLY

FORMATION RECORD

Give formation names and tops, if available, or descriptions and thickness of formations drilled through. Show intervals cored or drillstem tested.

LEASE NAME RIPLEY WELL NO 1H-31

NAMES OF FORMATIONS	TOP
Checkerboard	3186'
Big Lime	3238'
Mississippian	3808'

FOR COMMISSION USE ONLY

ITD on file  YES  NO

APPROVED DAN DISAPPROVED \_\_\_\_\_

2) Reject Codes \_\_\_\_\_

Were open hole logs run?  yes  no

Date Last log was run 9/25/08 (Scientific - GR log)

Was CO<sub>2</sub> encountered?  yes  no at what depths?

Was H<sub>2</sub>S encountered?  yes  no at what depths?

Were unusual drilling circumstances encountered?  yes  no  
If yes, briefly explain.

Other remarks:

---



---



---



---

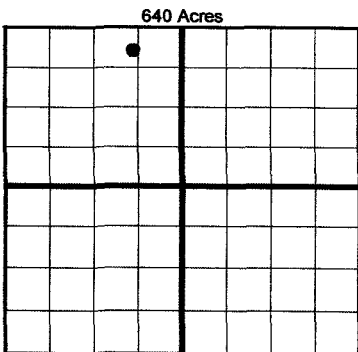

**BOTTOM HOLE LOCATION FOR DIRECTIONAL HOLE**

SEC	TWP	RGE	COUNTY
Spot Location	1/4 1/4 1/4 1/4		
Measured Total Depth	True Vertical Depth	BHL From Lease, Unit, or Property Line:	
		FSL	FWL

**BOTTOM HOLE LOCATION FOR HORIZONTAL HOLE: (LATERALS)**

**LATERAL #1**

SEC	TWP	RGE	COUNTY
31	22N	4E	Pawnee
Spot Location	SE 1/4 NW 1/4 NE 1/4 NW 1/4		
Depth of Deviation	3538'	Radius of Turn	433'
Measured Total Depth	7200'	True Vertical Depth	3908'
End Pt Location From Lease, Unit or Property Line:		387' FNL	1942' FWL

If more than three drainholes are proposed, attach a separate sheet indicating the necessary information.

Direction must be stated in degrees azimuth. Please note, the horizontal drainhole and its end point must be located within the boundaries of the lease or spacing unit.

**Directional surveys are required for all drainholes and directional wells.**

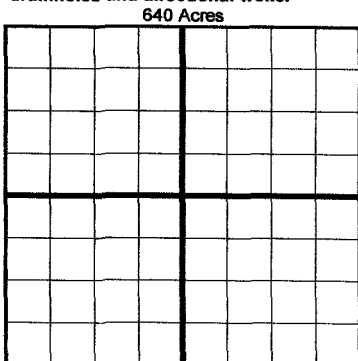

**LATERAL #2**

SEC	TWP	RGE	COUNTY
Spot Location	1/4 1/4 1/4 1/4		
Depth of Deviation	Radius of Turn	Direction	Total Length
Measured Total Depth	True Vertical Depth	End Pt Location From Lease, Unit or Property Line:	

**LATERAL #3**

SEC	TWP	RGE	COUNTY
Spot Location	1/4 1/4 1/4 1/4		
Depth of Deviation	Radius of Turn	Direction	Total Length
Measured Total Depth	True Vertical Depth	End Pt Location From Lease, Unit or Property Line:	