

API NO. 149-21359  
 OTC PROD. UNIT NO.

Rule 165.10-3-25  
 ORIGINAL  
 AMENDED  
 Reason Amended \_\_\_\_\_

Field: Sentinel

**COMPLETION REPORT**  
**OKLAHOMA CORPORATION COMMISSION**  
 Oil & Gas Conservation Division  
 Post Office Box 52000  
 Oklahoma City, Oklahoma 73152-2000

Form 1002A  
 Rev. 2001

Granite Wash  
**000GRWS-810272035**  
**COMPLETION & TEST DATA BY PRODUCING FORMATION**

PLEASE TYPE OR USE BLACK INK ONLY

NOTE: Attach copy of original 1002A if recompletion or reentry

TYPE OF DRILLING OPERATION

STRAIGHT HOLE  DIRECTIONAL HOLE \_\_\_\_\_ HORIZONTAL HOLE \_\_\_\_\_

If directional or horizontal, see reverse for bottom hole location.

COUNTY	Washita	SEC	17	TWP	08N	RGE	20W
LEASE NAME	Herring		WELL NO.		1-17		
SHL	SW/4 NE/4 NE/4 NE/4		2200 FS 1/4 Sec Line		2110 FW 1/4 Sec Line		
ELEVATION	Derrick Fl	1692	Ground	1668	SPUD DATE	4/12/2008	
DRLG FINISHED	5/16/2008		WELL COMPLETION		1/26/2008		
1ST PROD DATE	N/A - Well P&A		RECOMP DATE				

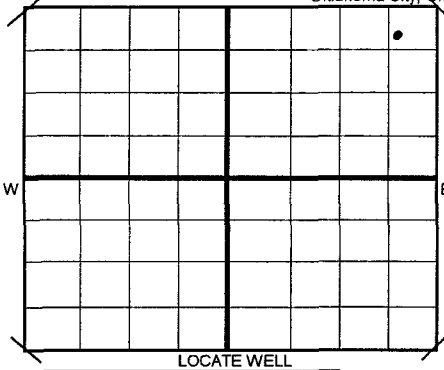

OPERATOR NAME	Marathon Oil Company	OTC/OCC OPERATOR NO.	01363-0
ADDRESS	North American Production Operations 5555 San Felipe Road, MS:3308		
CITY	Houston	STATE	TX
		ZIP	77253

<b>COMPLETION TYPE</b>	
<input checked="" type="checkbox"/> SINGLE ZONE	
MULTIPLE ZONE ORDER NO.	
COMMINGLED ORDER NO.	
<input checked="" type="checkbox"/> LOCATION EXCEPTION ORDER NO.	551137
INCREASED DENSITY ORDER NO.	556523fg
PENALTY	

<b>OIL OR GAS ZONES</b>		
FORMATIONS	TOP	BOTTOM
Granite Wash	7634'	8349'

<b>CASING &amp; CEMENT (Form 1002C must be attached)</b>								
TYPE	SIZE	WEIGHT	GRADE	FEET	PSI	SAX	FILLUP	TOP
Conductor								
Surface	9 5/8"	43.5#	P-110	1546	550	660	Circulate	Surface
Intermediate								
Production	4 1/2"	15.1#	P-110	9141	3400	1480	6385	2756
PACKER @		BRAND & TYPE		TOTAL DEPTH	TMD 10,900'	PBTD 9,097'		

PLUG @	CIBP	TYPE	7,570'
PLUG @		TYPE	
PLUG @		TYPE	
PLUG @		TYPE	
PLUG @		TYPE	

FORMATION	Granite Wash	Granite Wash
SPACING & SPACING ORDER NUMBER	177595 640	177595 640
CLASS: Oil, Gas, Dry, Inj, Disp, Comm Disp	Dry	Dry
PERFORATED INTERVALS	8,345-349' 8,302-309' 8,286-288' 8,274-277' 8,264-267'	7,634-637' 7,666-669' 7,684-691' 7,744-748' 7,808-810'
ACID/VOLUME	1150 gal 15% HCl	1918 gal 15% HCl
Fracture Treated?	Yes	Yes
Fluids Amounts	119,795 gal Slickwater 83,963 lbs 30/50 Econoprop	142,333 gal Slickwater 96,057 lbs 30/50 Econoprop

<b>INITIAL TEST DATA</b>	
INITIAL TEST DATE	None
OIL-BBL/DAY	
OIL-GRAVITY ( API)	
GAS-MCF/DAY	
GAS-OIL RATIO CU FT/BBL	
WATER-BBL/DAY	
PUMPING OR FLOWING	
INITIAL SHUT-IN PRESSURE	
CHOKE SIZE	
FLOW TUBING PRESSURE	

A record of the formations drilled through, and pertinent remarks are presented on the reverse. I declare that I have knowledge of the contents of this report and am authorized by my organization to make this report, which was prepared by me or under my supervision and direction, with the data and facts stated herein to be true, correct, and complete to the best of my knowledge and belief.

*Shawna C. Yezak*  
 SIGNATURE  
 Marathon Oil Company

Shawna C. Yezak - Regulatory Compliance Representative  
 NAME (PRINT OR TYPE)

P.O. Box 3487 Houston TX 77253-3487  
 MAILING ADDRESS CITY STATE ZIP

10/13/08 713/ 296-3305  
 DATE PHONE NUMBER

PLEASE TYPE OR USE BLACK INK ONLY  
FORMATION RECORD

Give formation names and tops, if available, or descriptions and thickness of formations drilled through. Show intervals cored or drillstem tested.

LEASE NAME Herring WELL NO. 1-17

NAMES OF FORMATIONS	TOP	BOTTOM
Brown Dolomite	2498'	2996'
Cisco	5195'	5521'
Hoxbar	5541'	6863'
Des Moines	7490'	8780'
Atoka	10,100'	10,900'

FOR COMMISSION USE ONLY	
APPROVED <i>SL</i>	DISAPPROVED
	1) ITD Section
	a) No Intent to Drill on file
	1) Send warning letter _____
	2) Recommend for contempt _____
	2) Reject Codes
	_____
	_____
	_____
	_____

Were open hole logs run?	<input checked="" type="checkbox"/> yes	<input type="checkbox"/> no
Date Last log was run	5/10/2008	
Was CO <sub>2</sub> encountered?	<input type="checkbox"/> yes	<input checked="" type="checkbox"/> no at what depths?
Was H <sub>2</sub> S encountered?	<input type="checkbox"/> yes	<input checked="" type="checkbox"/> no at what depths?
Were unusual drilling circumstances encountered?	<input type="checkbox"/> yes	<input checked="" type="checkbox"/> no
If yes, briefly explain.		

Other remarks:  
Well was drilled as a dry hole. Therefore, please accept this as the completion and P & A 1002A Completion.

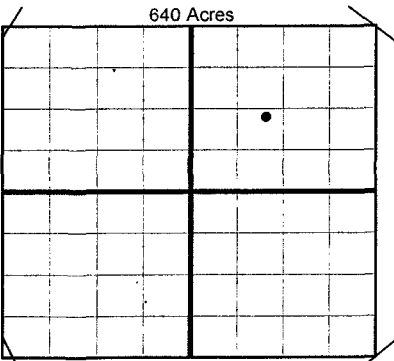

If more than two drainholes are proposed, attach a separate sheet indicating the necessary information.

Direction must be stated in degrees azimuth.  
Please note, the horizontal drainhole and its end point must be located within the boundaries of the lease or spacing unit.

**Directional surveys are required for all drainholes and directional wells.**

BOTTOM HOLE LOCATION			
SEC 17	TWP 08N	RGE 20W	COUNTY Washita
Spot Location		Feet From Quarter Section Lines	
		1643'	FSL 522' FWL
Measured Total Depth 10,900'		True Vertical Depth 10,783'	
BHL From Lease, Unit, or Property Line: 330'			

BOTTOM HOLE LOCATION FOR HORIZONTAL HOLE: (DRAINHOLES)			
DRAINHOLE #1			
SEC	TWP	RGE	COUNTY
Spot Location	Feet From Quarter Section Lines		
1/4	1/4	1/4	1/4
Depth of Deviation	Radius of Turn	Direction	Total Length
Measured Total Depth	True Vertical Depth	End Pt Location From Lease, Unit or Property Line:	

DRAINHOLE #2			
SEC	TWP	RGE	COUNTY
Spot Location	Feet From Quarter Section Lines		
1/4	1/4	1/4	1/4
Depth of Deviation	Radius of Turn	Direction	Total Length
Measured Total Depth	True Vertical Depth	End Pt Location From Lease, Unit or Property Line:	