

Instructions

- A. Please type or print using black ink.
- B. Form must be signed by former operator and new operator.
- C. Outline boundaries of lease and spot well being transferred.
- D. Attach 1002A for well.
- E. Questions should be directed to Well Records (405) 521-2275.

OKLAHOMA CORPORATION COMMISSION

Oil & Gas Conservation Division
 Post Office Box 52000
 Oklahoma City, OK 73152-2000

611030610

Form 1073
 Rev. 2001

Transfer of Operator
 OAC 165:10-1-15

API No. 03722212		OTC Prod. Unit No. 03758581	
Location 1/4 NW 1/4 NW 1/4 NW 12		Twp. 18N	Rge. 8E
Ft FSL of Qtr Sec 2310 NORTH	Ft FWL of Qtr Sec 330 EAST	County CREEK	
Current Well Name/No. SIDWELL NO. 1			
Original Well Name/No. SAME			
Unit Name (if applicable)			

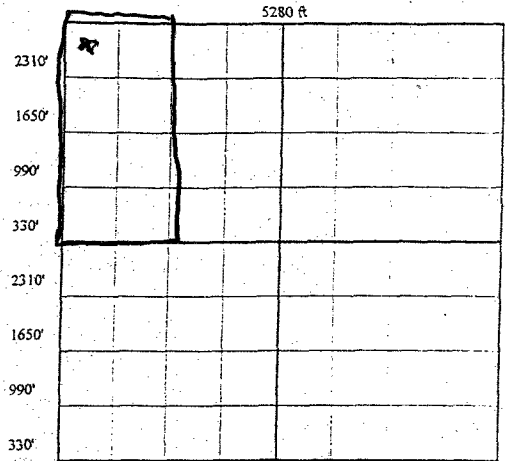

Well Class: Oil Gas Dry Plugged

Producing formation(s) LOWER RED FORK SKINNER PALE	OTC No. 15814
Oil Transporter/Purchaser DUKE ENERGY	OTC No. 00099
Gas Measurer ASSD NAT GAS INC	

The effective date of transfer of this well for the purposes of Commission records, is the date the transfer is approved by the Commission.

CURRENT OPERATOR

Name LUCRE OIL CO.	OCC No. 19727
Address 201 SO 33 #911	
City MUSKOGEE	State OK Zip 74401
Phone No. 9186822795	FAX No. -

I verify that I am the legal operator of record with authority to transfer operatorship of this well.

Signature **E.H. Fitzgerald**

Name & Title (Typed or Printed) **E.H. FITZGERALD, OWNER**
 Notary Public **KIM LEE** State of Oklahoma
 Signed and sworn to before me this **10** day of **Oct** 2006
 My Commission expires **March 08, 2007**
 Commission # **0303372**
 Notary Public

NEW OPERATOR

Name Well Renewal Inc.	OCC No. 21782
Address 320 S. BOSTON Suite 1026	
City Tulsa	State OK Zip 74103
Phone No. 918-595-5101	FAX No. 918.512-4337

Being the new operator, as of the effective date and time of transfer accept the facts presented as being true and correct and accept the operational responsibility for the well on the described property.

Signature **E.W. Gray II**

Name & Title (Typed or Printed) **Everett Wilfred Gray II CEO**
 Signed and sworn to before me this **20** day of **OCT** 2006.
 Notary Public **DANIELLE DAVIS** State of Oklahoma
 My Commission expires **01-17-2010**
 Commission # **06000656**

I verify under oath that I have exercised due diligence in attempting to locate the current operator of record according to OCC records, who has abandoned the above well/lease and cannot be located to obtain signature. I have attached a copy of the certified recorded assignment of lease.

Signature

Signed and sworn to before me this _____ day of _____

My commission expires: _____

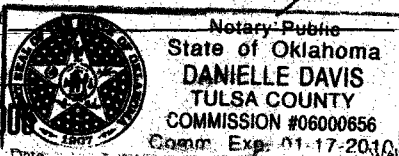

Notary Public

FOR OCC USE ONLY

Surety Dept. Approved Rejected Date **NOV 08 2006**

Well Records Dept. Approved Rejected Date **NOV 09 2006**

NOTE: By processing this Form 1073, the Oklahoma Corporation Commission has approved the contents thereof as to form only. Oklahoma Corporation Commission does not warrant that the facts provided by the operator are true. Form is not approved until approved by Well Records.

WDMS