

API NO.
35-073-24529
OTC PROD. UNIT NO.
073-117778

Rule 165:10-3-25
 ORIGINAL
 AMENDED
Reason Amended _____

COMPLETION REPORT
OKLAHOMA CORPORATION COMMISSION
Oil & Gas Conservation Division
P. O. Box 52000
Oklahoma City, Oklahoma 73152-2000

158748

Form 1002A
Rev. 2001

603272008
351 2310
Z69 HAITU
COMPLETION & TEST DATA BY PRODUCING FORMATION

PLEASE TYPE OR USE BLACK INK ONLY

NOTE: Attach copy of original 1002A if recompletion or reentry

TYPE OF DRILLING OPERATION

STRAIGHT HOLE DIRECTIONAL HOLE HORIZONTAL HOLE

If directional or horizontal, see reverse for bottom hole location.

COUNTY KINGFISHER	SEC 17	TWP 19N	RGE 8W
LEASE NAME RICHARD	WELL NO. 1-17		
C NW 1/4 NW 1/4 SE 1/4 2310 FSL 330 FWL OF 1/4 SEC			
ELEVATION Derrick FL 1211 Ground 1195	SPUD DATE 12/9/2005		
DRLG FINISHED 12/23/2005	WELL COMPLETION 2/24/2006		
1ST PROD DATE 2/11/2006	RECOMP DATE		

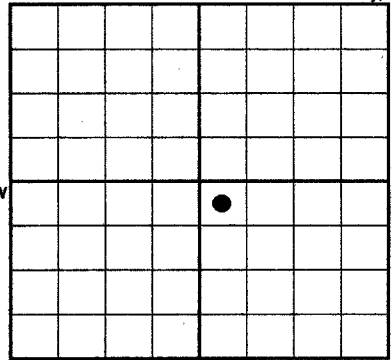

FORMATION	MISSISSIPPI LIME	ADDITIONAL MISS LIME PERFS	HUNTON
SPACING & SPACING ORDER NUMBER	80 94423	7698-7710 7714-7720	80 94423
CLASS: Oil, Gas, Dry, Inj, Disp, Comm Disp	7772-7777		7772-7777
PERFORATED INTERVALS	OIL 7574-7580 7582-7586 7632-7634 7648-7655 7678-7682 7693-7696	7878-7790 7840-7846 7852-7856 7864-7870 7878-7884 ADDITIONAL PERFS ON BACK	OIL 8113-8132 8172-8180 8197-8208 8214-8220 8300-8304 8344-8350
ACID/VOLUME			
Fracture Treated?	2000 GAL 15% HCL 97,000# sand		2000 gal inhib 15# HCL, 6800 BSW
Fluids Amounts	8725 BSW		6783 BLW 73,500# sand

OPERATOR NAME CHESAPEAKE OPERATING, INC.	OTC/OCC OPERATOR NO. 17441
ADDRESS P. O. BOX 18496	
CITY OKLAHOMA CITY	STATE OK
	ZIP 73154

COMPLETION TYPE	SINGLE ZONE
	MULTIPLE ZONE ORDER NO.
<input checked="" type="checkbox"/>	COMMINGLED ORDER NO. PENDING 523140
	LOCATION EXCEPTION ORDER NO. N/A
	INCREASED DENSITY ORDER NO. 512638
	PENALTY

OIL OR GAS ZONES	TOP	BOTTOM
FORMATIONS		
MISSISSIPPI LIME	7,571	8,111
HUNTON	8,111	8442

INITIAL TEST DATA	
INITIAL TEST DATE	2/24/2006
OIL-BBL/DAY	28
OIL-GRAVITY (API)	
GAS-MCF/DAY	40
GAS-OIL RATIO CU FT/BBL	1,429
WATER-BBL/DAY	58
PUMPING OR FLOWING	Pumping
INITIAL SHUT-IN PRESSURE	
CHOKE SIZE	
FLOW TUBING PRESSURE	30

COMMINGLED MISSISSIPPI LIME & HUNTON

CASING & CEMENT (Form 1002C must be attached)								
TYPE	SIZE	WEIGHT	GRADE	FEET	PSI	SAX	FILLUP	TOP
Conductor								
Surface	8 5/8"	24#	J-55	1,031		455		SURFACE
Intermediate								
Production	5 1/2"	17#	J-55	8,500		625		4,720
Liner								

PACKER @ _____ BRAND & TYPE _____ TOTAL DEPTH 8,500

PLUG @ _____ TYPE _____

A record of the formations drilled through, and pertinent remarks are presented on the reverse. I declare that I have knowledge of the contents of this report and am authorized by my organization to make this report, which was prepared by me or under my supervision and direction, with the data and facts stated herein to be true, correct, and complete to the best of my knowledge and belief.

David Craycraft
SIGNATURE

DAVID CRAYCRAFT - DISTRICT MANAG
NAME (PRINT OR TYPE)

P.O. BOX 18496 OKLAHOMA CITY OK 73154
ADDRESS CITY STATE ZIP

3/21/2006 405-848-8000
DATE PHONE NUMBER

PLEASE TYPE OR USE BLACK INK ONLY

FORMATION RECORD

Give formation names and tops, if available, or descriptions and thickness of formations drilled through. Show intervals cored or drillstem tested.

LEASE NAME RICHARD

WELL NO. 1-17

NAMES OF FORMATIONS	TOP	SUBSEA
Base Heebner	4,863	-3,658
Endicott	4,924	-3,719
B/Avant	5,950	-4,745
Cottage Grove	5,998	-4,793
Oswego	6,648	-5,441
Verdigris	6,856	-5,651
Red Fork	7,020	-5,815
Chester Lime	7,186	-5,981
Mississippi Lime	7,571	-6,366
Woodford	8,077	-6,872
Hunton	8,111	-6,908
Sylvan	8,442	-7,237

FOR COMMISSION USE ONLY

[Signature] DISAPPROVED

1) ITD Section

a) No Intent to Drill on file

1) Send warning letter _____

2) Recommend for contempt _____

2) Reject Codes

R

4/14/06

Were open hole logs run? yes no

Date Last log was run 12/22/2005

Was CO₂ encountered? yes no at what depths?

Was H₂S encountered? yes no at what depths?

Were unusual drilling circumstances encountered? yes no
If yes, briefly explain.

Other remarks:
ADDITIONAL MISSISSIPPI LIME PERFS: 7890-7896, 7914-7920, 7928-7932, 7934-7940, 7994-8000, 8014-8021.

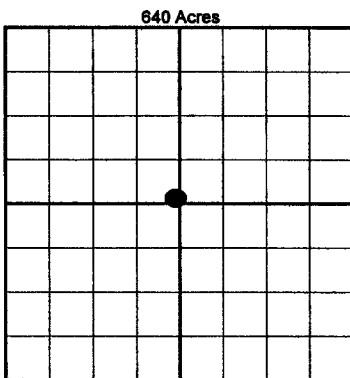

BOTTOM HOLE LOCATION

SEC	TWP	RGE	COUNTY
Spot Location			Feet From Quarter Section Lines
1/4	1/4	1/4	1/4 FSL FWL
Measured Total Depth		True Vertical Depth	BHL From Lease, Unit, or Property Line:

BOTTOM HOLE LOCATION FOR HORIZONTAL HOLE: (DRAINHOLES)

DRAINHOLE #1

SEC	TWP	RGE	COUNTY
Spot Location			Feet From Quarter Section Lines
1/4	1/4	1/4	1/4 FSL FWL
Depth of Deviation		Radius of Turn	Direction Total Length
Measured Total Depth		True Vertical Depth	End Pt Location From Lease, Unit or Property Line:

If more than two drainholes are proposed, attach a separate sheet indicating the necessary information.

Direction must be stated in degrees azimuth.

Please note, the horizontal drainhole and its end point must be located within the boundaries of the lease or spacing unit.

Directional surveys are required for all drainholes and directional wells.

DRAINHOLE #2

SEC	TWP	RGE	COUNTY
Spot Location			Feet From Quarter Section Lines
1/4	1/4	1/4	1/4 FSL FWL
Depth of Deviation		Radius of Turn	Direction Total Length
Measured Total Depth		True Vertical Depth	End Pt Location From Lease, Unit or Property Line: