

File Original Only
Please Type or Use Black Ink

OKLAHOMA CORPORATION COMMISSION

Oil & Gas Conservation Division
Post Office Box 52000
Oklahoma City, Oklahoma 73152-2000

RECEIVED Form 1023
Rev. 2007

MAR 09 2015

1. API No.	35-047-24899
2. OTC Prod. Unit No.	047-119998
3. Date of Application	3/3/2015

4. Application For (check one)

- ☒ A. Commingle Completion in the Wellbore (165:10-3-39)
☐ B. Commingle Completion at the Surface (165:10-3-39)
☐ C. Multiple (Dual) Completion (165:10-3-36)
☐ D. Downhole Multiple Choke Assembly (165:10-3-37)

5. Operator Name	R.E. BLAIK, INC.	OTC/OCC No.	16832	Email	reblaik@coxinet.net
Address	1616 E. 19TH STREET SUITE 201			Phone No.	405-285-8000
City	EDMOND	State	OK	Zip	73013
6. Lease Name/Well No.	GRACIE NO. 1-1			FAX No.	405-285-8003
Location within section:	1/4 NE 1/4 SW 1/4 NE 1/4	Sec. 1	Twp 20N	Rge 4W	County GARFIELD

8. The following facts are submitted:	UPPER ZONE	INTERMEDIATE ZONE	LOWER ZONE
A. Name of common source of supply	LAYTON		OSWEGO
B. Top and bottom of pay section (perforations)	4871-4883'		5215-5235'
C. Type of production (oil or gas)	OIL		OIL
D. Method of production (flowing or art. lift)	ART LIFT		ART LIFT
E. Latest test data by zone (oil, gas, and water)	8		10
F. Wellhead or bottom hole pressure	2200		2300
G. Spacing order number and size of unit	320AC / 526833		320AC / 526833
H. Increased density order number	NA		625707
I. Location exception order number and penalty	632330		632330

Oklahoma Corporation Commission
Oil & Gas Division
Approved

If 4A, 4B or 4D above, and size of the units under 8G above are not the same, have the different allocations been addressed?

☒ Yes ☐ No

9. List all operators with mailing addresses within 1/2 mile, producing from the above listed zones.
EAGLE ROCK MID CONTINENT
1717 S BOULDER, SUITE 100 TULSA, OK 74119

10. The operators listed above have been notified and furnished a copy of this application.

If no, an affidavit of mailing must be filed not later than five (5) days after submission of this application.

☒ Yes ☐ No

11. Classification of well (see OAC 165:10-13-2)

☒ Oil ☐ Gas

12. ATTACH THE FOLLOWING:

- A. Correlation log section (porosity, resistivity, or gamma ray) with top and bottom of perforated intervals marked. *log*
B. Diagrammatic sketch of the proposed completion of the well.
C. Plat showing the location of all wells within 1/2 mile producing from the zones listed above.
D. If 4B, 4C or 4D above, a Form 1024, Packer Setting Report, and a Form 1025 Packer Leakage Test.
E. If 4A, 4B or 4D above, and size of the units under 8G above are not the same, have the different allocations been addressed?

☒ Yes ☐ No

I hereby certify that I am authorized to submit this application which was prepared by me or under my supervision. The facts and proposals made herein are true correct and complete to the best of my knowledge and belief.

Signature

PRESIDENT

Title

405-285-8000

Phone (AC/NO)

OCC USE ONLY

Staff Signature	Phone No.	Date	<input checked="" type="checkbox"/> Approved <input type="checkbox"/> Rejected
-----------------	-----------	------	--

GRACIE NO. 1-1

WELL BORE SCHEMATIC

NE/4, SECTION 1-T20N-R4W

GARFIELD COUNTY, OKLAHOMA

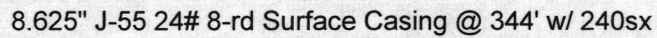

5.5" J-55 15.5# 8-rd Casing @ 5383' w/ 200 sx

TOC @ 4408'

5.5" x 2.375" TAC (Baker-Type) @ 4700'

Layton Perforations: 4871-83' (48)

Oswego Perforations: 5215-35' (80)

2.875" J-55 6.5# EUE 8-rd Tubing (EOT @ 5270') (SSN @ 5240')

208-3/4" Grade D sucker Rods w/ 25-150 RWBC 16-5 Pump

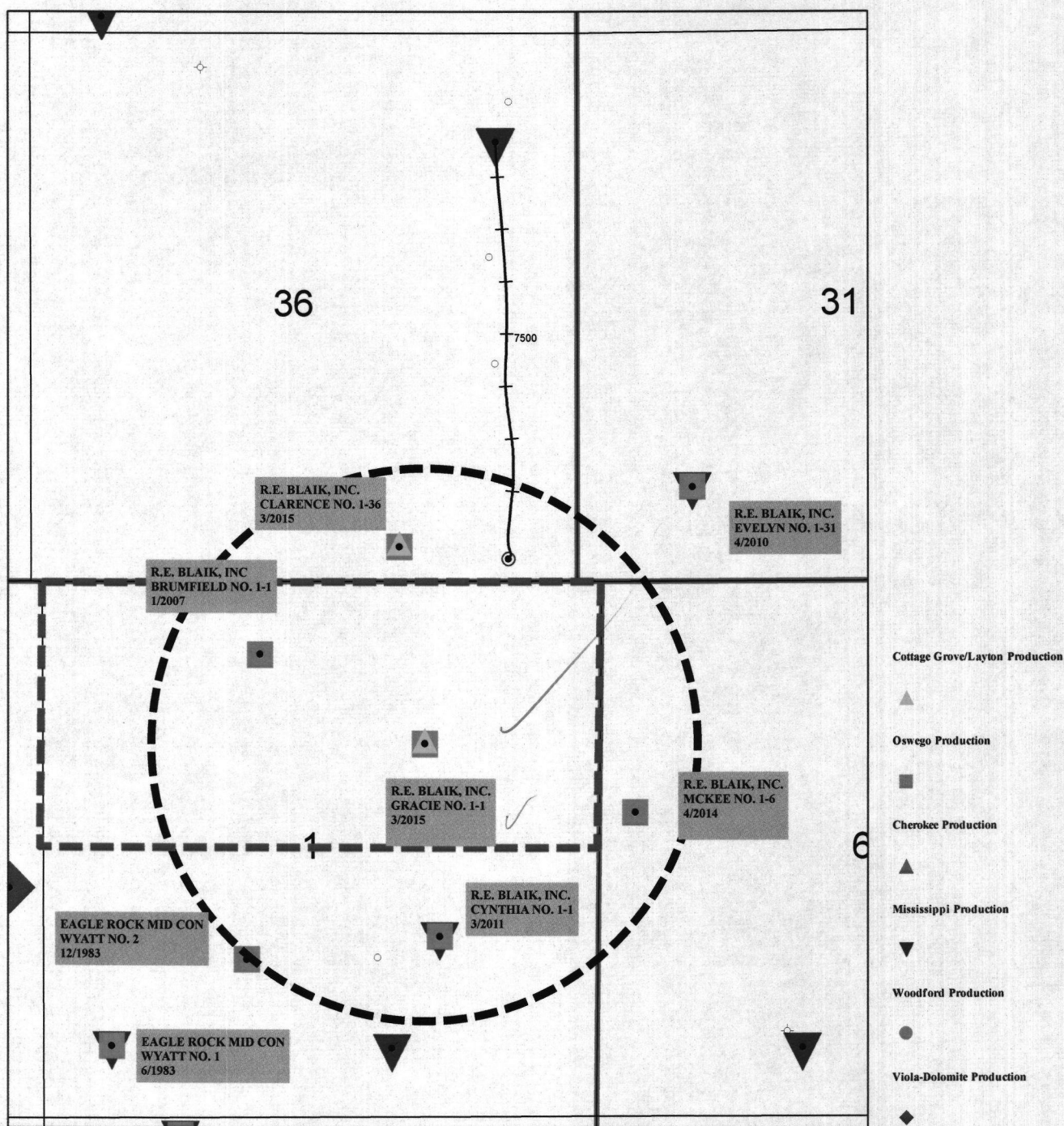

EXHIBIT FORM 1023	R.E. BLAIK, INC.
T20 & 21N-R3 & 4W GARFIELD COUNTY, OKLAHOMA	
RESERVOIR LIMIT 1/2 MILE RADIUS OPERATOR PRODUCING ZONE(S) COMPLETION DATE	
Date: 27 February, 2015	Geology & Geophysics: B. Blaik

GRACIE 1-1
BLAIK R E INC
TWP: 20 N - Range: 4 W - Sec. 1
Datum=1090.00

