

1. API No.	083 - 24213 A ✓
2. OTC Prod. Unit No.	083-21294900
3. Date of Application	4/7/2014

4. Application For (check one)

- A. Commingle Completion in the Wellbore (165:10-3-39)
 B. Commingle Completion at the Surface (165:10-3-39)
 C. Multiple (Dual) Completion (165:10-3-36)
 D. Downhole Multiple Choke Assembly (165:10-3-37)

5. Operator Name	Stephens Production Company	OTC/OCC No.	23030 - 0 ✓	Email	jchen@stephenspro.com
Address	623 Garrison Avenue			Phone No.	479-783-4191
City	Fort Smith	State	AR	Zip	72902
6. Lease Name/Well No.	Jane # 3-16H ✓			FAX No.	479-424-1190
Location within section:	SE 1/4 SW 1/4 SE 1/4 SE 1/4	Sec. 16	Twp 16N	Rge 4W	County Logan ✓

8. The following facts are submitted:	UPPER ZONE	INTERMEDIATE ZONE	LOWER ZONE
A. Name of common source of supply	Woodford ✓	Hunton ✓	
B. Top and bottom of pay section (perforations)	7511 - 7672 ✓	7722 - 12060 ✓	
C. Type of production (oil or gas)	oil	oil	
D. Method of production (flowing or art. lift)	art. lift	art. lift	
E. Latest test data by zone (oil, gas, and water)	830/dwy ✓	8780/dwy ✓	
F. Wellhead or bottom hole pressure	-	-	
G. Spacing order number and size of unit	616223/640 ✓	616223/640 ✓	
H. Increased density order number	N/A	N/A	
I. Location exception order number and penalty	621611 ✓	616788 ✓	

Oklahoma Corporation Commission
Oil & Gas Division
Approved

If 4A, 4B or 4D above, and size of the units under 8G above are not the same, have the different allocations been addressed? Yes No

9. List all operators with mailing addresses within 1/2 mile, producing from the above listed zones.	
Covington Oil Co. Inc,	100Park Ave.Bldg.Ste1004,OK City,73102
Midwest Interprises, Inc	Rt 1 Box 403, Cashion, OK 73016

10. The operators listed above have been notified and furnished a copy of this application. Yes No
If no, an affidavit of mailing must be filed not later than five (5) days after submission of this application.

11. Classification of well (see OAC 165:10-13-2) Oil Gas

RECEIVED

12. ATTACH THE FOLLOWING:

A. Correlation log section (porosity, resistivity, or gamma ray) with top and bottom of perforated intervals marked.	ok ✓
B. Diagrammatic sketch of the proposed completion of the well.	✓
C. Plat showing the location of all wells within 1/2 mile producing from the zones listed above.	✓
D. If 4B, 4C or 4D above, a Form 1024, Packer Setting Report, and a Form 1025 Packer Leakage Test.	✓
E. If 4A, 4B or 4D above, and size of the units under 8G above are not the same, have the different allocations been addressed?	<input type="checkbox"/> Yes <input type="checkbox"/> No

OKLAHOMA CORPORATION COMMISSION

I hereby certify that I am authorized to submit this application which was prepared by me or under my supervision. The facts and proposals made herein are true correct and complete to the best of my knowledge and belief.

Jennifer Chen Signature Regulatory Analyst Title 479-783-4191 Phone (AC/NO)

OCC USE ONLY

<u>S.A</u> Staff Signature	Phone No.	<u>4,26,14</u> Date	<input checked="" type="checkbox"/> Approved	<input type="checkbox"/> Rejected
----------------------------	-----------	---------------------	--	-----------------------------------

(Handwritten initials)

File Original Only
Please Type or Use Black Ink

OKLAHOMA CORPORATION COMMISSION
Oil & Gas Conservation Division
Post Office Box 52000
Oklahoma City, Oklahoma 73152-2000

Form 1023
Rev. 2007

1. API No.	083 - 24213 A
2. OTC Prod. Unit No.	083-21294900
3. Date of Application	4/7/2014

4. Application For (check one)

- A. Commingle Completion in the Wellbore (165:10-3-39)
 B. Commingle Completion at the Surface (165:10-3-39)
 C. Multiple (Dual) Completion (165:10-3-36)
 D. Downhole Multiple Choke Assembly (165:10-3-37)

5. Operator Name	Stephens Production Company	OTC/OCC No.	23030 - 0	Email	jchen@stephenspro.com
Address	623 Garrison Avenue			Phone No.	479-783-4191
City	Fort Smith	State	AR	Zip	72902
6. Lease Name/Well No.	Jane # 3-16H			FAX No.	479-424-1190
Location within section:	SE 1/4 SW 1/4 SE 1/4 SE 1/4	Sec. 16	Twp 16N	Rge 4W	County Logan

8. The following facts are submitted:	UPPER ZONE	INTERMEDIATE ZONE	LOWER ZONE
A. Name of common source of supply	Woodford	Hunton	
B. Top and bottom of pay section (perforations)	7511 - 7672	7722 - 12060	
C. Type of production (oil or gas)	oil	oil	
D. Method of production (flowing or art. lift)	art. lift	art. lift	
E. Latest test data by zone (oil, gas, and water)	8 BO/d	87 BO/d	
F. Wellhead or bottom hole pressure	-	-	
G. Spacing order number and size of unit	616223	616223	
H. Increased density order number	-	-	
I. Location exception order number and penalty	621611	616788	

If 4A, 4B or 4D above, and size of the units under 8G above are not the same, have the different allocations been addressed? Yes No

9. List all operators with mailing addresses within 1/2 mile, producing from the above listed zones.	
Covington Oil Co. Inc.	100Park Ave.Bldg.Ste1004,OK City,73102
Midwest Interprises, Inc	Rt 1 Box 403, Cashion, OK 73016

10. The operators listed above have been notified and furnished a copy of this application. Yes No
 If no, an affidavit of mailing must be filed not later than five (5) days after submission of this application.

11. Classification of well (see OAC 165:10-13-2) Oil Gas

12. ATTACH THE FOLLOWING:	
A. Correlation log section (porosity, resistivity, or gamma ray) with top and bottom of perforated intervals marked.	
B. Diagrammatic sketch of the proposed completion of the well.	
C. Plat showing the location of all wells within 1/2 mile producing from the zones listed above.	
D. If 4B, 4C or 4D above, a Form 1024, Packer Setting Report, and a Form 1025 Packer Leakage Test.	
E. If 4A, 4B or 4D above, and size of the units under 8G above are not the same, have the different allocations been addressed?	<input checked="" type="checkbox"/> Yes <input type="checkbox"/> No

I hereby certify that I am authorized to submit this application which was prepared by me or under my supervision. The facts and proposals made herein are true correct and complete to the best of my knowledge and belief.

Jerry Chen Signature Regulatory Analyst Title 479-783-4191 Phone (AC/NO)

OCC USE ONLY

Staff Signature	Phone No.	Date	<input type="checkbox"/> Approved <input type="checkbox"/> Rejected
-----------------	-----------	------	---

DIAGRAMMATIC SKETCH SHOWING MULTIPLE COMPLETION INSTALLATION

Date		4/7/2014	
Operator		Stephens Production Company	
Lease		Jane # 3-16H	
Location within Sec.		SE SW SE SE	
Sec	Twp	Rge	
16	16N	4W	
County		Logan	
Field		Navina North	
Casing Set Depth	Total Depth		
4 1/2"	12,172'		

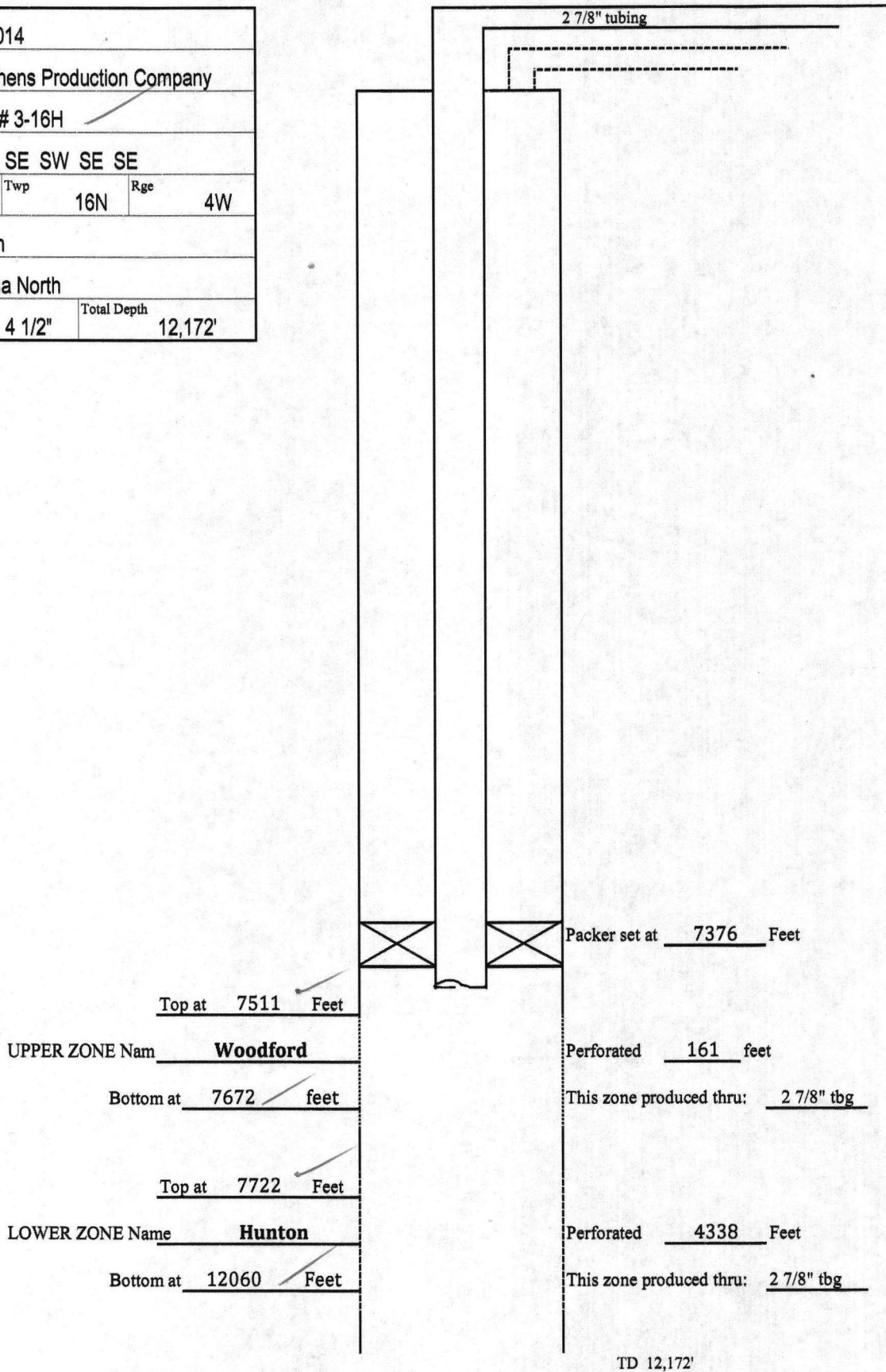

NOTE: This form is furnished only as an example. The diagrammatic sketch which is filed should depict the particular installation for which approval is being requested.

Stephens Production

SPC Jane No.3-16

Production Plat

Sec.16 16N-4W

Logan Co. OK

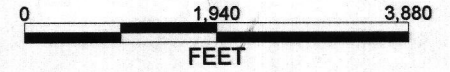

ATTRIBUTE MAP

- Zone: PRODUCTION - O_269HNTN IS PRESENT
- Zone: PRODUCTION - O_319WDFD IS PRESENT

By: SH

April 4, 2014

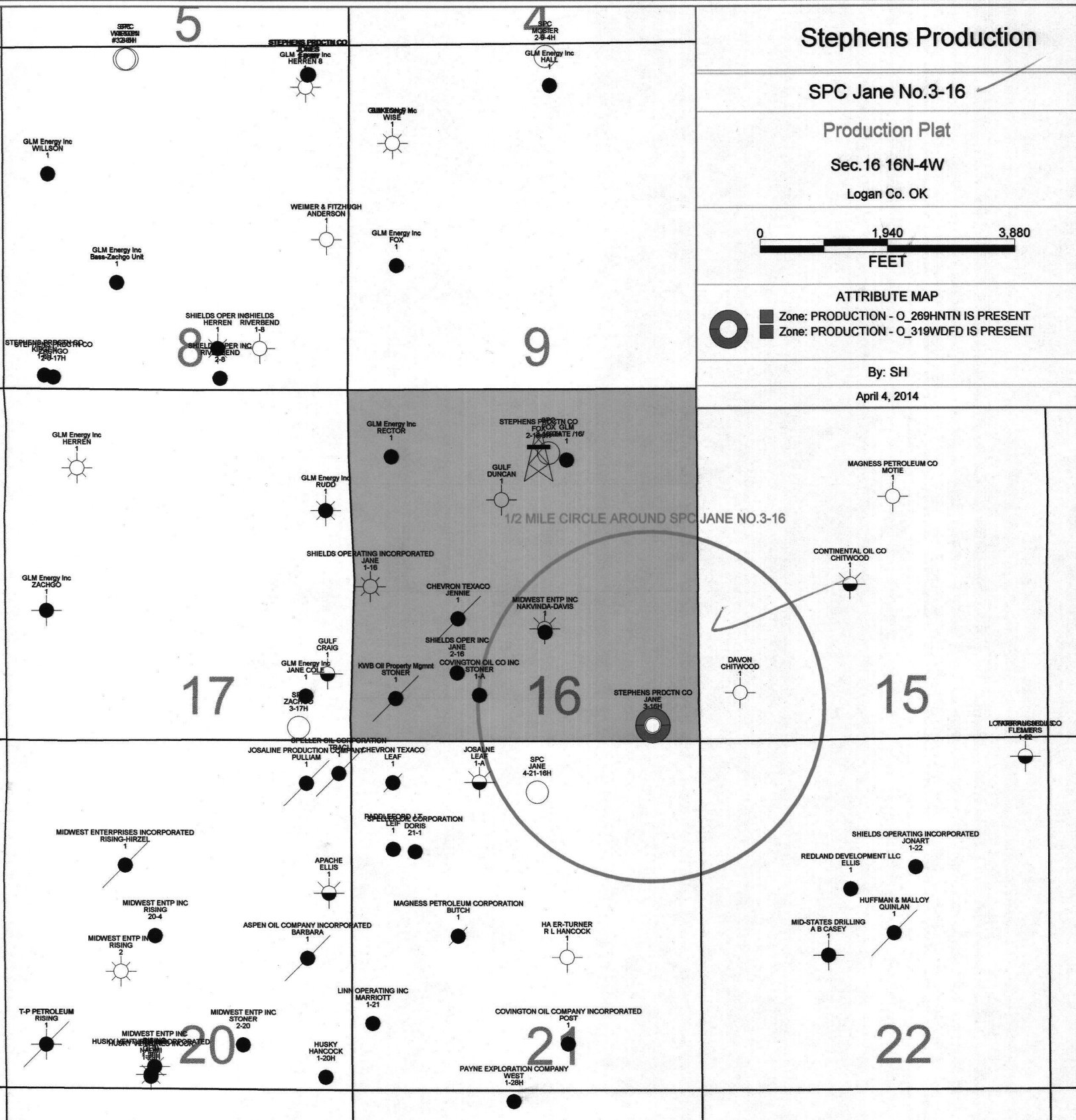

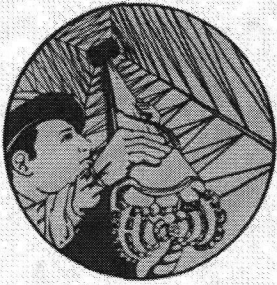

STEPHENS PRODUCTION COMPANY

P.O. Box 2407 • 623 Garrison Avenue
Fort Smith, Arkansas 72902-2407

April 14, 2014

Oklahoma Corporation Commission
Oil & Gas Conservation Division
P O Box 52000-2000
Oklahoma City, OK 73152-2000

Re: Form 1023 (12a)
Jane # 3-16H ✓
Section 16-T16N-R4W
Logan County, Ok
API # 083-24213 A

Gentlemen:

In lieu of the electric logs for the captioned well, we encountered hole stability issues which led us to make the decision to not run open hole logs. Due to concerns about the integrity of the wellbore, we wanted to leave the hole open for as short of a time as possible before running and cementing the 4 1/2" liner.

If you need any additional information, please contact me.

Yours sincerely,

STEPHENS PRODUCTION COMPANY

Jennifer Chen
Regulatory Analyst