

File Original Only
Please Type or Use Black Ink

OKLAHOMA CORPORATION COMMISSION
Oil & Gas Conservation Division
Post Office Box 52000
Oklahoma City, Oklahoma 73152-2000

Form 1023
Rev. 2007

1. API No.	129-20369 ✓
2. OTC Prod. Unit No.	129-60605
3. Date of Application	1/7/2013

4. Application For (check one)

- A. Commingle Completion in the Wellbore (165:10-3-39)
 B. Commingle Completion at the Surface (165:10-3-39)
 C. Multiple (Dual) Completion (165:10-3-36)
 D. Downhole Multiple Choke Assembly (165:10-3-37)

5. Operator Name	WAGNER & BROWN, LP	OTC/OCC No.	18918 ✓	Email	bharris @wbltd.com			
Address	P.O. BOX 1714			Phone No.	432-682-7936			
City	MIDLAND	State	TEXAS	Zip	79702			
6. Lease Name/Well No.	STATE OF OKLAHOMA # 1- 16 ✓			FAX No.	432-686-5928			
Location within section:	1/4	1/4	1/4 C SW 1/4	Sec. 16	Twp 14N	Rge 26W ✓	County	ROGER MILLS ✓

8. The following facts are submitted:	UPPER ZONE	INTERMEDIATE ZONE	LOWER ZONE
A. Name of common source of supply	MARMATON ✓		CHEROKEE ✓
B. Top and bottom of pay section (perforations)	11690' - 12108' ✓		12246' - 12742' ✓ 12250' - 12742' ✓
C. Type of production (oil or gas)	GAS		GAS
D. Method of production (flowing or art. lift)	FLOWING ✓		FLOWING ✓
E. Latest test data by zone (oil, gas, and water)	6 bopd, 451 mcf, 342 bwpd		2 bopd, 193 mcf, 147 bwpd
F. Wellhead or bottom hole pressure	3175 psi SITP ✓	Oil & Gas Division	2700 psi SITP ✓
G. Spacing order number and size of unit	#148257/640 acres ✓	Approved	#148257/640 acres ✓
H. Increased density order number	NONE		NONE ✓
I. Location exception order number and penalty	NONE		NONE ✓

If 4A, 4B or 4D above, and size of the units under 8G above are not the same, have the different allocations been addressed? Yes No

9. List all operators with mailing addresses within 1/2 mile, producing from the above listed zones.

NONE ✓

10. The operators listed above have been notified and furnished a copy of this application. Yes No
 If no, an affidavit of mailing must be filed not later than five (5) days after submission of this application.

11. Classification of well (see OAC 165:10-13-2) Oil Gas

12. ATTACH THE FOLLOWING:

A. Correlation log section (porosity, resistivity, or gamma ray) with top and bottom of perforated intervals marked. ✓

B. Diagrammatic sketch of the proposed completion of the well. ✓

C. Plat showing the location of all wells within 1/2 mile producing from the zones listed above. ✓

D. If 4B, 4C or 4D above, a Form 1024, Packer Setting Report, and a Form 1025 Packer Leakage Test Report. ✓

E. If 4A, 4B or 4D above, and size of the units under 8G above are not the same, have the different allocations been addressed? Yes No

I hereby certify that I am authorized to submit this application which was prepared by me or under my supervision. The facts and proposals made herein are true correct and complete to the best of my knowledge and belief.

[Signature] Senior Petroleum Engineer 432-686-5931
 Signature Title Phone (AC/NO)

OCC USE ONLY

Staff Signature _____ Phone No. _____ Date 1, 24, 13 Approved Rejected

STATE OF OKLAHOMA # 1 - 16

SEC 16-14N-26W, 1320' FSL & 1320' FWL
ROGER MILLS COUNTY, OKLAHOMA

KB=2463'
DF=2461'
GL=2441'

35-129-20369
SPUD 12-27-78
COMPL 6-2-79

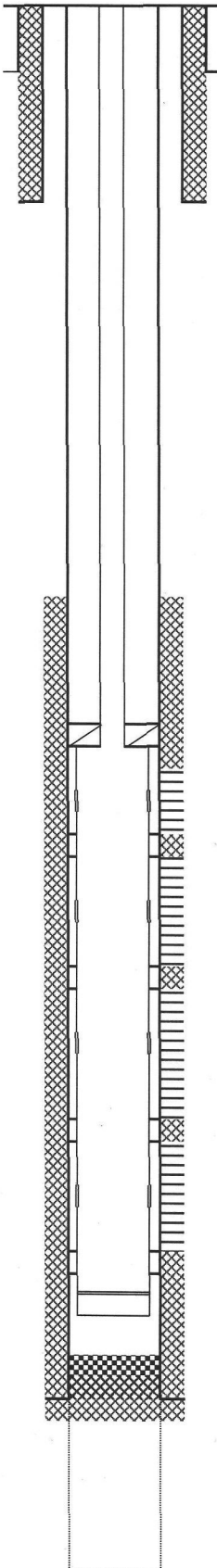

TOC 8-5/8" @ SURFACE: TOPPED OFF W/200 SX CEMENT DOWN 1"

16" CONDUCTOR @ 52', 12-27-78

8-5/8" K-55 STC CASING SET @ 3,454'
RAN 941.01'(21 JTS) 32# + 2442'(56 JTS) 24# + 90.54'(2 JTS)32#
CEMENT W/2800 SX, 1-3-79

TOC 5-1/2" @ 11,145'

RAN 357 JTS. 2 3/8" 4.70# L-80 EUE,
10', 8', 6', (SUBS 1JT. BELOW OG TBG.)
12/16/12. 2 3/8" SCREWED INTO 3 1/2"
LEFT 5 JTS. OF 3 1/2" TBG. IN HOLE,
EOT OF 3 1/2" @ 11,443' 12/15/12

TOP OF 3-1/2" L-80 PACKER PLUS ASSEMBLY: BAKER S-3 PACKER SET @ 11,611'

PACKER #1 @ 11,930'; 2.375" FRAC SLEEVE 11,770'

PACKER #2 @ 12,186'; 2.250" FRAC SLEEVE 12,060'

PACKER #3 @ 12,449'; 2.125" FRAC SLEEVE @ 12,287'

PACKER #4 @ 12,768', PRESSURE SLEEVE @ 12,640'

END OF 3-1/2" L-80 PACKER PLUS ASSEMBLY 12,870', BALL SEAT @ 12,804'

EZ DRILL PLUG @ 14,500', 3-25-79
PUMP IN 25 SX CEMENT

5-1/2" LTC CASING SET @ 14,560'
RAN 50 JTS 20# S-95 + 271 JTS 17# S-95 + 45 JTS 20# P-110
CEMENT W/720 SX, 3-6-79

TD 15,042', 3-24-79

PROPOSED NEW PERFORATIONS:

11690'-94'
11720'-26'
11790-96'
11818'-28'
11876'-82'
12002'-07'
12030'-35'
12070'-74'
12102'-08'

Marmaton Formation

ORIGINAL COMPLETION PERFS:

12246' -314'	PERF'D 4-13-79
12594' -604'	PERF'D 4-13-79
12610' - 24'	PERF'D 4-13-79
12716' - 30'	PERF'D 4-13-79
12732' -42'	PERF'D 4-13-79

Cherokee Formation

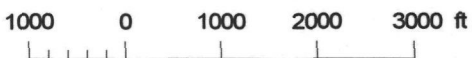
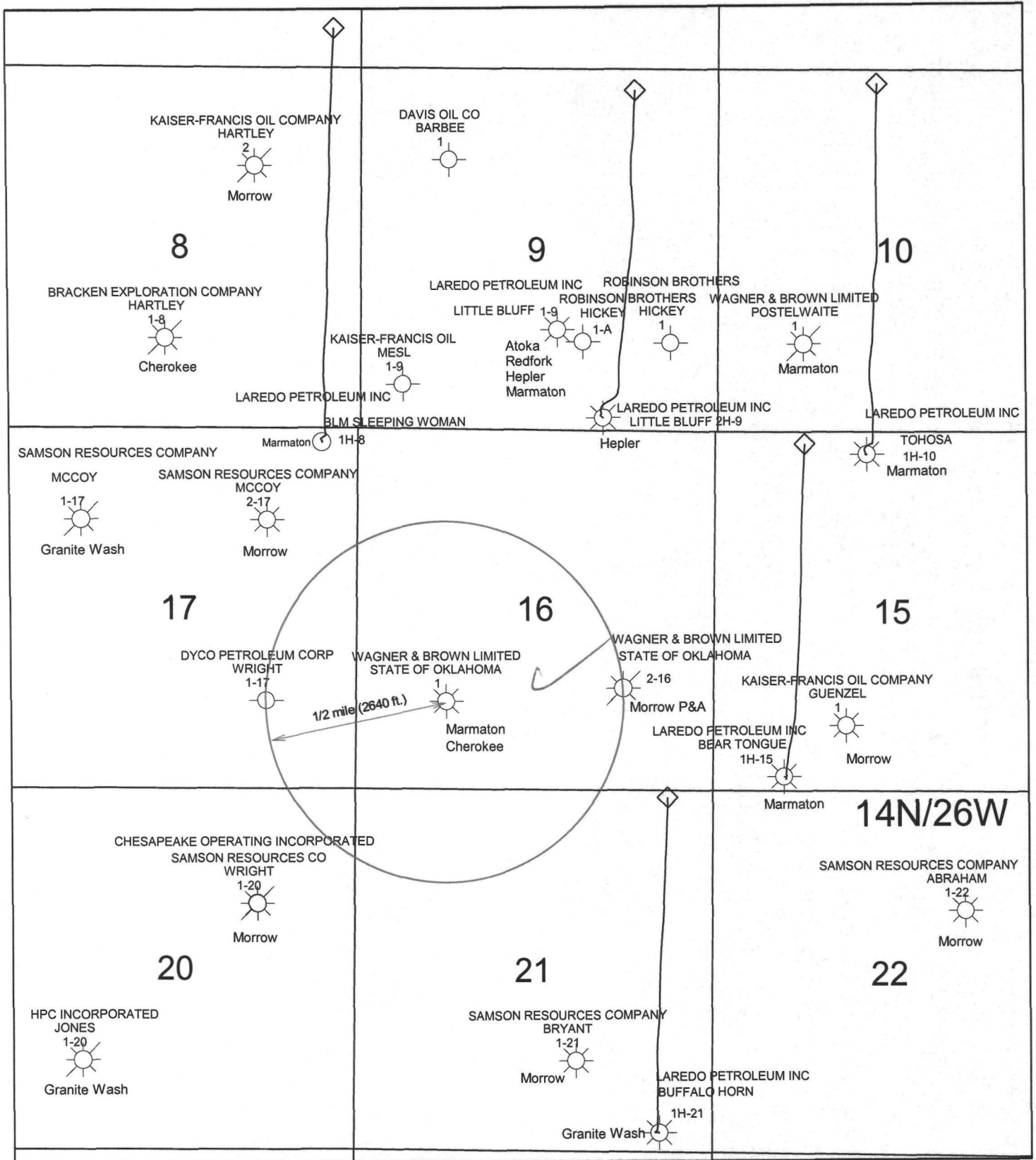

1 inch = 2000 feet

Location Plat
Wagner & Brown LTD (18918)
State of Oklahoma # 1-16
API # 3512920369

BOB ANTHONY
Commissioner

PATRICE DOUGLAS
Commissioner

DANA MURPHY
Commissioner

OKLAHOMA
CORPORATION COMMISSION
P.O. BOX 52000
OKLAHOMA CITY, OKLAHOMA 73152-2000

258 Jim Thorpe Building
Telephone: (405) 521-2489

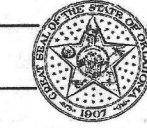

OIL & GAS CONSERVATION DIVISION

Technical Services Dept.

Q1000.UNAUTH:1023

January 04, 2013

18918-0

WAGNER AND BROWN LP
ATTN: BILLY W HARRIS
PO BOX 1714
MIDLAND, TX 79702-1714

RE: STATE OF OKLAHOMA 1-16, API 129-20369-01, C SW 16-14N-26W, ROGER MILLS COUNTY

Dear Mr. Harris:

It has come to our attention that the above well was recompleted without a properly-approved Form 1000 Drilling Permit, in violation of Rule 165:10-3-1. The well has also been producing from two or more common sources of supply in a commingled status without first filing an application to commingle on Form 1023, and obtaining subsequent approval to commingle the well, as required by Rule 165:10-3-39.

We are requesting that you submit an amended Form 1000 Permit to Drill with the required \$175 fee, and a Form 1023 with supporting documentation, within 15 days from the date of receipt of this letter. Please submit these items together along with a copy of this letter, marked to the attention of the staff member named in the closing sentence. On your payment, please specify "permit fee," along with the name and API Number for this well.

If you have any further questions regarding the submission of these items within the allotted time, please contact Dennis Niskern at (405) 522-2977.

Sincerely,

A handwritten signature in black ink that reads "Duncan Woodliff".

Duncan Woodliff
Compliance Section

xc: OCC Office of General Counsel



BOB ANTHONY
Commissioner

PATRICE DOUGLAS
Commissioner

DANA MURPHY
Commissioner

OKLAHOMA
CORPORATION COMMISSION
P.O. BOX 52000
OKLAHOMA CITY, OKLAHOMA 73152-2000

258 Jim Thorpe Building
Telephone: (405) 521-2489

OIL & GAS CONSERVATION DIVISION

Technical Services Dept.



W 1000 UNAUTH.1023

January 04, 2013

18918-0
WAGNER AND BROWN LP
ATTN: BILLY W HARRIS
PO BOX 1714
MIDLAND, TX 79702-1714

RE: STATE OF OKLAHOMA 1-16, API 129-20369-01, C SW 16-14N-26W, ROGER MILLS COUNTY

Dear Mr. Harris:

It has come to our attention that the above well was recompleted without a properly-approved Form 1000 Drilling Permit. The well was also listed as producing from two or more common sources of supply as a commingled well without first submitting Form 1023 with supporting documentation, and obtaining subsequent approval. This is a violation of Rules 165:10-3-1 and 165:10-3-39, which carry respective fines of \$1000 and \$500 per incident violation.

This letter serves as your notification and warning against any further violations of these rules. We are maintaining records of these warnings; if you fail to comply with these rules for any of your subsequent wells, we will have not alternative but to initiate legal proceedings against your company. Such proceedings may result in the levying of substantial fines and penalties against your company.

If you have any further questions regarding this matter, please feel free to contact Dennis Niskern at (405) 522-2977.

Sincerely,

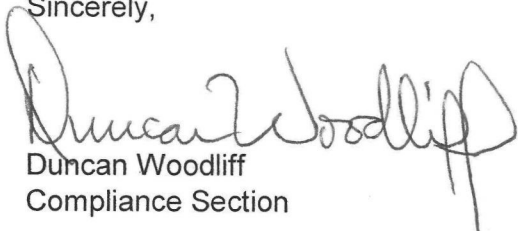
Duncan Woodliff
Compliance Section

xc: OCC Office of General Counsel